

How to get the best from **Your Refrigerator**

Contents

Appliance Registration	2
Care and Cleaning	6
Defrosting	5
Energy-Saving Tips	2
Ice Service	5
Installation	3,4
Adapter Plug	4
Clearances	4
Electrical Requirements	3, 4
Extension Cord	4
Grounding	3
Location	4
Model and Serial Numbers	2
Moving & Vacation Tips	6
Operating Instructions	4
Problem Solver	7
Repair Service	7
Safety Instructions	3
Temperature Control	4
Warranty	Back Cover

GE Answer Center[®]
800.626.2000

Use and Care of
compact models

SSD2
SSD4

HOTPOINT

Help us help you...

Read this book carefully.

It is intended to help you operate and maintain your new refrigerator properly.

Keep it handy for answers to your questions.

If you don't understand something or need more help, write (include your phone number):

Consumer Affairs
Hotpoint
Appliance Park
Louisville, KY 40225

Write down the model and serial numbers.

You'll see them on a label on the rear wall of the refrigerator.

These numbers are also on the Consumer Product Ownership Registration Card that came with your refrigerator.

Before sending in this card, please write these numbers here:

Model Number

Serial Number

Use these numbers in any correspondence or service calls concerning your refrigerator.

If you received a damaged refrigerator, immediately contact the dealer (or builder) that sold you the refrigerator.

Save time and money.

Before you request service, check the Problem Solver on page 7. It lists causes of minor operating problems that you can correct yourself.

Energy-saving tips

. Location of your refrigerator is important. Avoid locating it next to your range, a heating vent or where the sun will shine directly on it.

- Don't open the door more often than necessary.
- Close the door as soon as possible, particularly in hot, humid weather.
- Defrost the ice storage compartment whenever frost becomes 1/4-inch thick.
- Be sure the door is closed tightly. Before leaving the house or retiring for the night, check to be sure the door has not been left open accidentally.
- Store only those foods requiring refrigeration in your refrigerator.
- . Wipe moisture from bottles and cartons before putting them in the refrigerator.
- . Keep foods covered to reduce moisture buildup inside the refrigerator.
- . If you turn the temperature control to the coldest position for quick chilling or faster freezing of ice cubes, be sure to turn it back to the regular setting.
- . Don't overcrowd your refrigerator. Overcrowding can require extra electrical energy to keep everything cool

IMPORTANT SAFETY INSTRUCTIONS

Read all instructions before using this appliance.

WARNING—when using this appliance, always exercise basic safety precautions, including the following:

- **Use this appliance only for its intended purpose** as described in this Use and Care Book.
- **This refrigerator must be properly installed in accordance with the Installation Instructions before it is used.** See “grounding” instructions below and on page 4.
- **This refrigerator should not be recessed or built in**—it is designed for free-standing installation only.
- **If model SSD2 is placed on a countertop or stand,** the front surface of the door should be 3” or more back from the edge of the countertop or stand to avoid accidental tipping of the appliance in normal usage.
- **Never unplug your refrigerator by pulling on the power cord.** Always grip plug firmly and pull straight out from the outlet.
- **Repair or replace immediately all electric service cords that have**

become frayed or otherwise damaged. Do not use a cord that shows cracks or abrasion damage along its length or at either the plug or connector end.

- **After your refrigerator is in operation, do not touch the cold surfaces, particularly when hands are damp or wet.** Skin may adhere to these extremely cold surfaces.

- **Don’t refreeze frozen foods which have thawed completely.** The United States Department of Agriculture in Home and Garden Bulletin No. 69 says:

“... You may safely refreeze frozen foods that have thawed if they still contain ice crystals or if they are still cold—below 40°F.

“... Thawed ground meats, poultry, or fish that have *any* off-odor or off-color should not be refrozen and should not be eaten. Thawed ice cream should be discarded. If the odor or color of any food is poor or questionable, get rid of it. The food may be dangerous to eat.

“... Even partial thawing and refreezing reduce the eating quality of

foods, particularly fruits, vegetables, and prepared foods. The eating quality of red meats is affected less than that of many other foods. Use refrozen foods as soon as possible to save as much of their eating quality as you can.”

- **Do not use any electrical device or any sharp instrument in defrosting your refrigerator.**

- **If your old refrigerator is still around the house but not in use, be sure to remove the doors.** This will reduce the possibility of danger to children.

- **Unplug your refrigerator:**

A. Before making any repairs.

Note: We strongly recommend that any servicing be performed by a qualified individual.

B. Before cleaning.

- **Do not operate your refrigerator in the presence of explosive fumes.**

SAVE THESE INSTRUCTIONS

Installation Requirement—IMPORT~T... Please Read Carefully.

How to connect electricity

For personal safety, this appliance must be properly grounded.

The power cord of this appliance is equipped with a three-prong (grounding) plug which mates with a standard three-prong (grounding) wall outlet (Fig. 1) to minimize the possibility of electric shock hazard from this appliance.

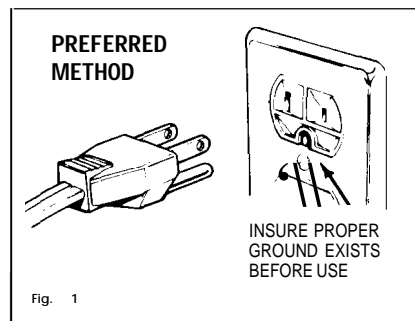

Have the wall outlet and circuit checked by a qualified electrician to make sure the outlet is properly grounded.

Where a standard two-prong wall outlet is encountered, it is your personal responsibility and obligation to have it replaced with a properly grounded three-prong wall outlet.

DO NOT, UNDER ANY CIRCUMSTANCES, CUT OR REMOVE THE THIRD (GROUND) PRONG FROM THE POWER CORD.

DO NOT REMOVE THE (GROUNDING) STRAP.

Instillation Requirements (continued)

IMPORTANT. . . Please Read Carefully.

Use of adapter plug

Because of potential safety hazards under certain conditions, we strongly recommend against use of an adapter plug. However, if you still elect to use an adapter, where local codes permit, a TEMPORARY CONNECTION may be made to a properly grounded two-prong wall outlet by use of a UL listed adapter (Fig. 2) available at most local hardware stores.

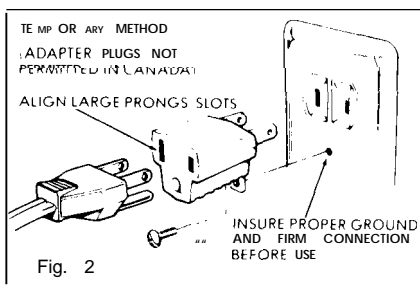

The larger slot in the adapter must be aligned with the larger slot in the wall outlet to provide proper polarity in the connection of the power cord.

CAUTION: Attaching adapter ground terminal to wall outlet cover screw does not ground the appliance unless cover screw is metal, and not insulated, and wall outlet is grounded through house wiring. You should have the circuit checked by a qualified electrician to make sure the outlet is properly grounded.

When disconnecting the power cord from the adapter, always hold the adapter with one hand. If this is not done, the adapter ground terminal is very likely to break with repeated use.

Should the adapter ground terminal break, DO NOT USE the appliance until a proper ground has again been established.

Use of extension cords

Because of potential safety hazards under certain conditions, we **strongly recommend against the use of an extension cord.** However, if you still elect to use an extension cord, it is absolutely necessary that it be a UL listed 3-wire grounding type appliance extension cord having a grounding type plug and outlet and that the electrical rating of the cord be 15 amperes (minimum) and 120 volts. Such extension cords are obtainable through your local service organization.

The refrigerator should always be plugged into its own individual electrical outlet—

(115 volt, 60 Hertz, single phase AC). This is recommended for best performance and to prevent overloading house wiring circuits, which could cause a possible fire hazard from overheating wires.

Refrigerator Installation

Location

This refrigerator is designed for free-standing installation only. It should not be recessed or built-in.

Install the refrigerator on a base strong enough to support a fully loaded refrigerator. If the base is not level, adjust the feet of the refrigerator.

If the refrigerator is in a 40°F. or colder room, it will operate but it will not cool foods properly.

Also see Energy-Saving Tips regarding location.

Clearance

Allow the following clearances for proper air circulation:

Top, 12" Back, 5" Sides, 1/2"

Operating Your Refrigerator

Temperature Control Dial

The temperature control dial has settings from "MIN" to "MAX" plus "OFF".

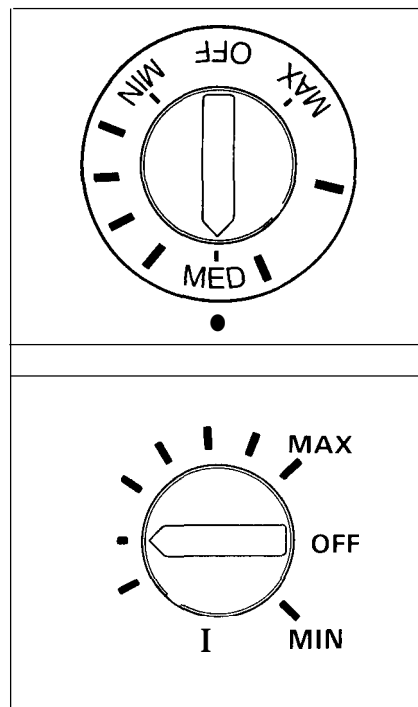

"MIN" is the warmest.

"MAX" is the coldest.

Initially set the temperature control dial at the midpoint.

After using the refrigerator for 24 hours, adjust the temperature control to the setting that is best suited to your needs.

Note:

If this refrigerator is unplugged or turned off, you must allow 3 minutes before restarting it or plugging it back in. If you attempt to restart it in less than 3 minutes, it will not start.

Note:

Turning temperature control dial to "OFF" stops cooling but does not shut off power to the refrigerator.

Ice Service

Ice trays

For most efficient ice service, place trays side by side on the ice tray compartment floor.

To release ice cubes, hold the tray upside down over an ice bucket or bowl, and twist tray at both ends.

If the ice tray freezes to the floor, pour a little lukewarm water around it to loosen it. Do not use boiling water which can damage plastic parts, or sharp metal objects such as a knife or screwdriver which can damage the cooling system tubing.

Wash trays in lukewarm water only. Do not put them in an automatic dishwasher.

Defrosting

Defrost whenever frost on the wall of the ice tray compartment becomes 1/4" thick.

Never use a sharp or metallic instrument to remove frost as it may damage the cooling coils. (A punctured cooling coil will cause serious problems and void the warranty.) We recommend using a plastic scraper.

Do not use any electrical device in defrosting your refrigerator.

To defrost, remove foods and ice trays from the ice tray compartment, put drip tray in place, and set temperature control dial at "OFF" position.

Defrosting usually takes a few hours. To defrost faster, keep the door open. Also, pouring warm (not hot) water on the frosted part may speed defrosting. **Do not use boiling water—it may damage plastic parts,**

After defrosting, empty water from the drip tray. Wash the drip tray in warm water. Wipe the ice tray compartment with a damp cloth. Then turn the temperature control to the desired setting and return food and ice trays to the refrigerator.

Note: If ice buildup is very thick, it may keep the ice tray compartment door from opening or closing completely. Don't try to force it open; after defrosting, the door will open and close easily.

Food Storage Suggestions

Multi-Position Shelves (Model SSD4 only)

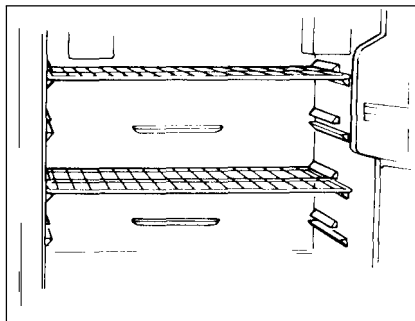

Two of the shelves can be moved to different levels to suit your varying food storage needs.

Ice Tray Compartment

- This compartment is designed for production of ice cubes and short-term storage (a few days at the most) of some commercially-frozen foods.
- The ice tray compartment should not be used to freeze foods.

When storing foods in your compact refrigerator, follow these suggestions for best results:

Meats, Fish & Poultry

- Always remove store wrappings.
- Rewrap in foil, film or wax paper and refrigerate immediately.

Cheese

- Cheese should be wrapped well with wax paper or aluminum foil, or put in a plastic bag.
- Carefully wrap to expel air and help prevent mold.
- Store pre-packaged cheese in its own wrapping if you wish.

Vegetables

- Crispness can be maintained by covering vegetables with a moist towel
- As a further aid to freshness, pre-packaged vegetables can be stored in their original wrapping.

Leftovers

- Open dishes of food, especially leftovers, should be covered. Leftovers should be used within 2 days.

Care and Cleaning

Cleaning—Inside

Unplug the refrigerator and **remove** food, shelf and trays. Wash inside with warm water and baking soda solution—about two tablespoons of baking soda to a quart of water. Then rinse and dry.

Don't use cleansers such as soaps, detergents, scouring powder or spray cleaners—they may cause odors inside the refrigerator.

Wash ice cube trays, drip tray and shelf in mild detergent solution and dry with a soft cloth.

To help prevent odors, leave an open box of baking soda in the rear of the refrigerator, on the shelf. Change the box every three months.

Wipe outside of refrigerator with a soft cloth dampened with soapy water or Appliance Polish Wax Cleaner (Cat. No. WR97X0216), available from Hotpoint Appliance Parts Marts.

Use only mild, soapy water to clean the door gasket.

Never use acids, chemical thinner, gasoline, benzine or the like for cleaning any part of the refrigerator. Boiling water or benzine may deform or damage plastic parts.

Do not wash any plastic parts from your refrigerator in your automatic dishwasher.

When going on vacation. . .

For extended vacations or absences, unplug the refrigerator and clean the interior. To prevent odors, leave an open box of baking soda inside and leave the door open.

For shorter vacations, remove perishable foods and leave the control at regular setting. However, if room temperature is expected to drop below 40 °F. follow the same instructions as for extended vacations.

When you move. . .

Disconnect the power cord from wall outlet, remove food and defrost refrigerator. Then clean and dry the interior.

Secure all loose items such as ice trays and drip tray by taping them securely in place to prevent damage.

Be sure refrigerator stays in upright position during actual moving and in van. Refrigerator must be secured in van to prevent movement. Protect outside of refrigerator with blanket.

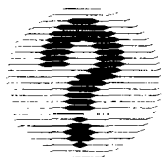

Questions? Use This Problem Solver

PROBLEM	POSSIBLE CAUSE AND REMEDY
REFRIGERATOR DOES NOT OPERATE	<ul style="list-style-type: none">• Not plugged in.• Circuit breaker tripped or fuse blown.
TURNS ON AND OFF FREQUENTLY	<ul style="list-style-type: none">• This is normal. Small refrigerators cycle more often than larger ones.
SEEMS TO RUN TOO LONG	<ul style="list-style-type: none">• Check for proper clearances.• Frequent door openings let cold air escape.
VIBRATION	<ul style="list-style-type: none">• If refrigerator vibrates, more than likely it is not level. Use shims to make it level.• On model SSD4, the left front leg is adjustable.
CABINET HAS ODOR	<ul style="list-style-type: none">• Foods with strong odors should be tightly covered.• Check for spoiled food.• Interior may need cleaning.• Keep an open box of baking soda in refrigerator; replace every three months.

If you need more help . . . call, toll free:
GE Answer Center[®]
800.626.2000
consumer information service

If You Need Service

To obtain service, see your warranty on the back page of this book.

We're proud of our service and want you to be pleased. If for some reason you are not happy with the service you receive, here are three steps to follow for further help.

FIRST, contact the people who serviced your appliance. Explain why you are not pleased. In most cases, this will solve the problem.

NEXT, if you are still not pleased, write all the details—including your phone number—to:

Manager, Consumer Relations
Hotpoint
Appliance Park
Louisville, Kentucky 40225

FINALLY, if your problem is still not resolved, write:

Major Appliance
Consumer Action Panel
20 North Wacker Drive
Chicago, Illinois 60606

YOUR HOTPOINT REFRIGERATOR WARRANTY

Save proof of original purchase date such as your sales slip or cancelled check to establish warranty period

WHAT IS COVERED

FULL ONE-YEAR WARRANTY

For one year from date of original purchase, we will provide, free of charge, parts and service labor to repair or replace **any part of the refrigerator** that fails because of a manufacturing defect.

LIMITED ADDITIONAL FOUR-YEAR WARRANTY

For the second through fifth year from date of original purchase, we will provide, free of charge, a **replacement compressor** if the compressor fails because of a manufacturing defect. You pay for any service labor charges.

For each of the above warranties:

You must take the refrigerator to a Hotpoint Factory Service Center or a Hotpoint Customer Care[®] servicer and pick it up following service. In-home service is also available, but you must pay for the service technician's travel costs to your home.

This warranty is extended to the original purchaser and any succeeding owner for products purchased for use in the 48 mainland states, Alaska, Hawaii and Washington, D.C.

All warranty service will be provided by our Factory Service Centers or by our authorized Customer Care[®] servicers during normal working hours.

Look in the White or Yellow Pages of your telephone directory for HOTPOINT FACTORY SERVICE, GENERAL ELECTRIC-HOTPOINT FACTORY SERVICE or HOTPOINT CUSTOMER CARE[®] SERVICE.

WHAT IS NOT COVERED

- Service trips to your home to teach you how to use the product.

Read your Use and Care material. If you then have any questions about operating the product, please contact your dealer or our Consumer Affairs office at the address below, or call, toll free:

GE Answer Center[®]
800.626.2000
consumer information service

- Improper installation.

If you have an installation problem, contact your dealer or installer. You are responsible for providing adequate electrical, plumbing and other connecting facilities.

- Replacement of house fuses or resetting of circuit breakers.

• Failure of the product if it is used for other than its intended purpose or used commercially.

• Damage to product caused by accident, fire, floods or acts of God.

WARRANTOR IS *NOT*
RESPONSIBLE FOR
CONSEQUENTIAL DAMAGES.

Some states do not allow the exclusion or limitation of incidental or consequential damages, so the above limitation or exclusion may not apply to you. This warranty gives you specific legal rights, and you may also have other rights which vary from state to state. To know what your legal rights are in your state, consult your local or state consumer affairs office or your state's Attorney General.

Warrantor: General Electric Company

If further help is needed concerning this warranty, write:
Manager—Consumer Affairs, GE Appliances, Appliance Park, Louisville, KY 40225