

GE Monogram®
36" Built-In Refrigerators

Custom
Options Guide
and
Installation
Instructions

With Custom Panel Dimensions
and Trim Kit
Installation Instructions

Models:
ZIS36NY
ZISW36DY
ZISB36DY

Monogram refrigerators offer a range of custom appearance options that can be achieved through the use of optional trim kits.

This package contains information and illustrations to demonstrate custom possibilities. Custom door and grille panel sizes vary to accommodate the kit being used. Dimensions for each application is provided herein.

Dimensions and specifications pages can be pulled out and faxed or sent to the cabinet manufacturer so that the panels can be constructed accurately.

Optional Trim Kit Installation Instructions are included for reference.

Monogram

Dimensions & Specifications

Introduction

Illustrations on the following pages will demonstrate the range of appearance options available. These options are accomplished through the use of one or more trim kits.

The door panel and grille panel sizes vary to accommodate the kit being used. Sizes are provided in this package.

Side panels must be used whenever the sides of the refrigerator will be exposed. Side panel sizes will also vary depending on the installation.

You should:

1. Select the appearance option.
2. Order the trim kit for that option.
3. Order the custom door and grille panels from the manufacturer. The exact dimensions for each trim kit application is

provided in this package. Find and pull out the page for your application and fax or send it to the manufacturer. The cabinet manufacturer must have this information to construct the panels accurately.

4. Determine the final installation situation and order matching side panels. Again, sizes vary. Provide this information to the cabinet manufacturer. Panel sizes for various applications are provided herein.

3/4" thick custom panels–Without trim kits
A raised panel design, screwed or glued to a 1/4" thick backing can be used. See page 7 for ZIS36NY panel sizes and details. See page 11 for ZISW36DY/ZISB36DY panel sizes and details.

Trim Kit Descriptions

ZKH1–Provides for the installation of a custom handle on the standard 1/4" custom panels.

ZG1–Provides 1/4" grille panel frame side pieces for 83", 83-1/2" and 84-1/2" installation heights. Factory set height is 84".

ZKT36–Provides for the installation of 3/4" custom door and grille panels, using the standard full length handle.

ZKHT1–Provides for the installation of a custom handle using 3/4" door and grille panels. This kit must be used in conjunction with ZKT36.

ZWCD1–Provides for the installation of a custom collar trim on the dispenser for one continuous custom panel on the freezer door. This kit can be used alone, or with all other kits.

Contents

Appearance Options	3-5
ZIS36NY, Dimensions & Specifications	
Design Information	6
1/4" Thick panels using standard trim	7
1/4" Thick panels using standard trim and ZKH1 trim kit	7
Thicker panels secured to 1/4" thick backing, using standard trim	7
3/4" Thick panels with ZKT36 trim kit.....	8
3/4" Thick panels with ZKT36 and ZKHT1 trim kits	9
ZISW36DY/ZISB36DY, Dimensions & Specifications	
Design Information	10
1/4" Thick panels using standard trim.....	11
1/4" Thick panels using standard trim, ZKH1 and ZWCD1 trim kits.....	11
Thicker panels secured to 1/4" thick backing, using standard trim	11
3/4" Thick panels with ZKT36 and/or ZWCD1 trim kits	12
3/4" Thick panels with ZKT36, ZKHT1 and/or ZWCD1 trim kits.....	13
Side Panel or Filler options	14
Product Installation	15-19
ZKH1 Trim Kit Installation Instructions	20-25
ZG1 Trim Kit Installation Instructions	26
ZKT36 Trim Kit Installation Instructions	27
ZKHT1 Trim Kit Installation Instructions	33
ZWCD1 Trim Kit Installation Instructions	38

Monogram

*Dimensions &
Specifications*

Appearance Options

Non-Dispenser Model:
ZIS36NY

The Standard Product
1/4" or 3/4" Panels With
Standard Handles. No trim
kits required.

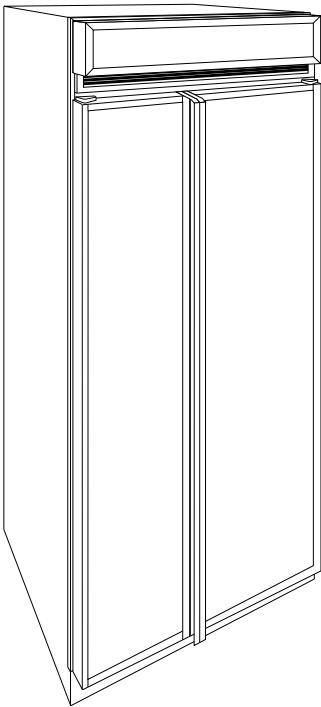

Dramatic effects are accomplished with the addition of trim kits

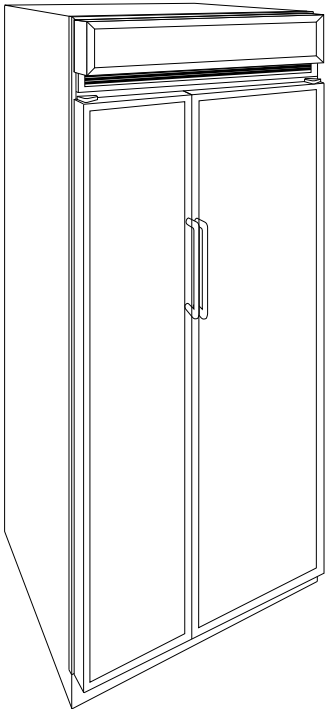

1/4" Custom Panels
With Custom Handles:
Trim Kit ZKH1

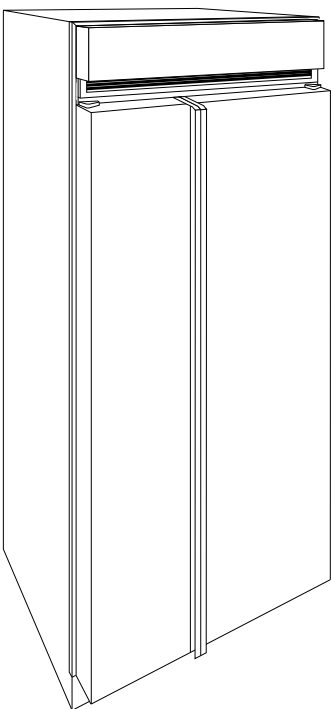

3/4" Custom Trimless
Panels With Standard
Handles: Trim Kit
ZKT36

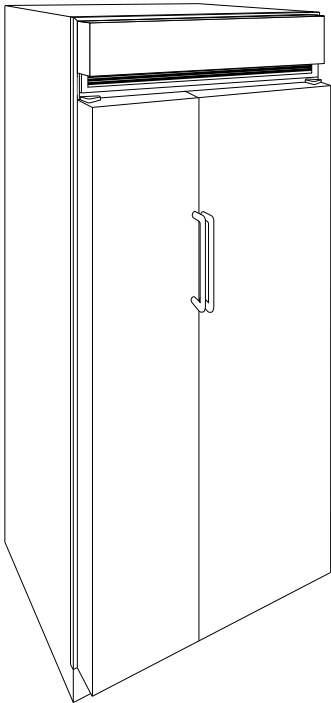

3/4" Custom
Trimless Panels With
Custom Handles:
Trim Kits ZKT36 &
ZKHT1

Monogram

*Dimensions &
Specifications*

Appearance Options

Dispenser Models using
Standard Dispenser
Full-Width Trim
ZISW36DY, ZISB36DY

The Standard Product
1/4" or 3/4" Panels With
Standard Handles. No Trim
Kits required.

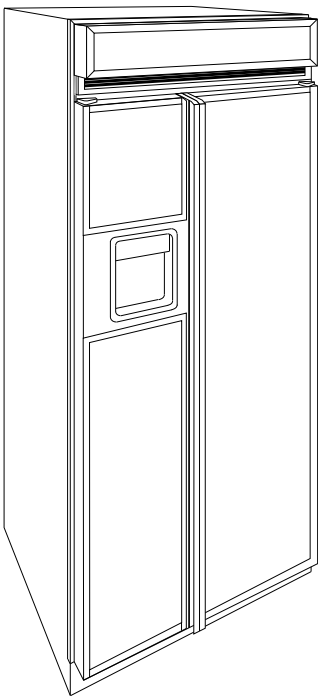

Dramatic effects are accomplished with the addition of trim kits

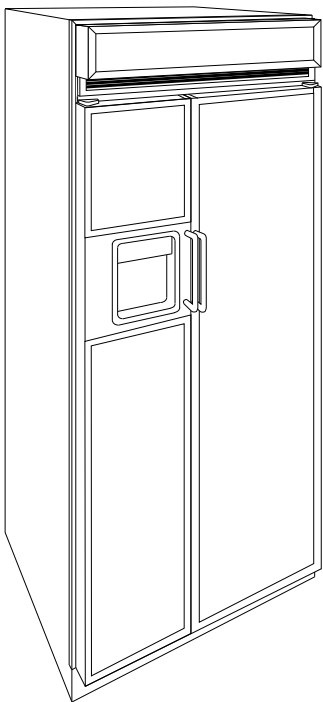

1/4" Custom Panels
With Custom Handles:
Trim Kit ZKH1

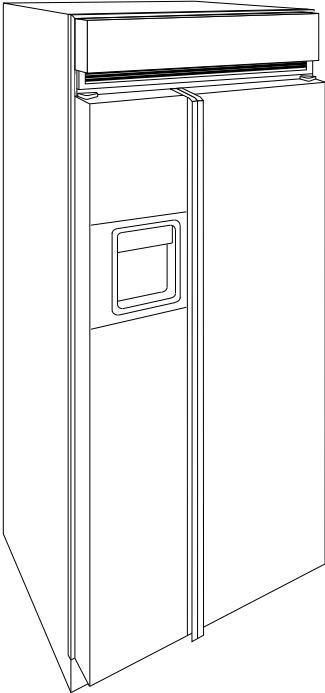

3/4" Custom Trimless
Panels With Standard
Handles: Trim Kit
ZKT36

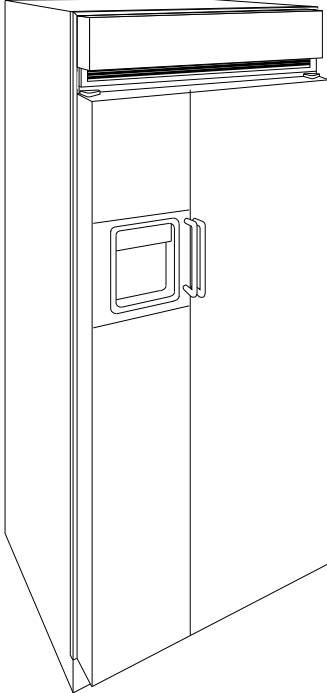

3/4" Custom
Trimless Panels With
Custom Handles:
Trim Kits ZKT36 &
ZKHT1

Monogram

*Dimensions &
Specifications*

Appearance Options

Dispenser Models with
ZWCD1 Custom Collar Trim Kit
ZISW36DY, ZISB36DY

The Standard Product
with Trim Kit ZWCD1 Custom Collar Trim Kit, 1/4" Custom Panels and Standard Handles

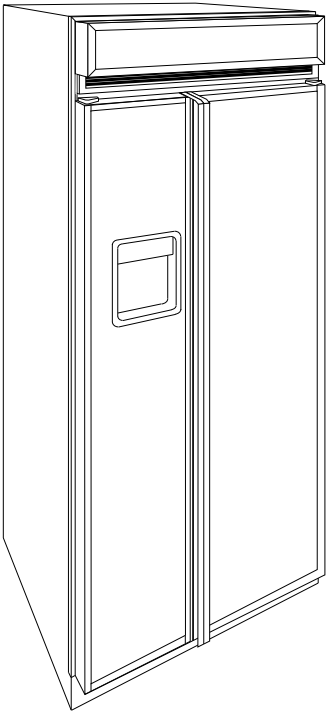

Dramatic effects are accomplished with additional trim kits

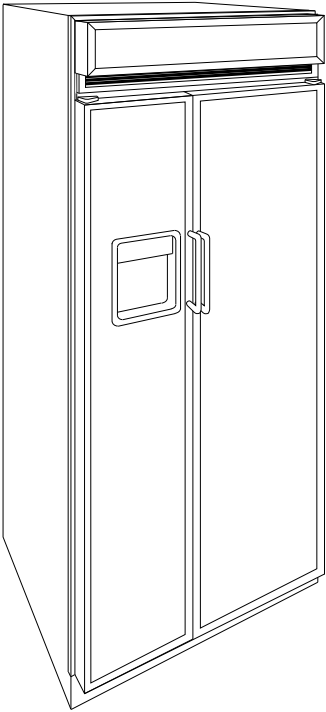

1/4" Custom Panels
With Custom Handles:
Trim Kits ZKH1 &
ZWCD1

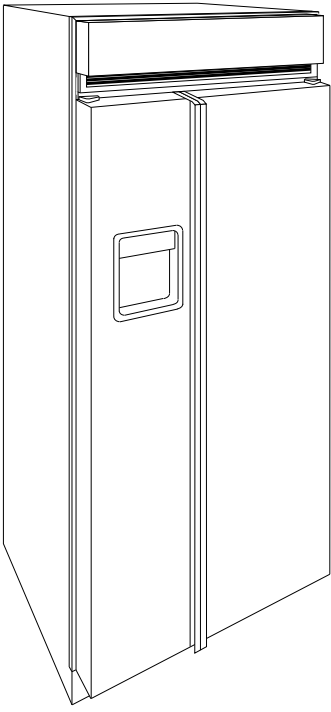

3/4" Custom Trimless
Panels With Standard
Handles: Trim Kits
ZKT36 & ZWCD1

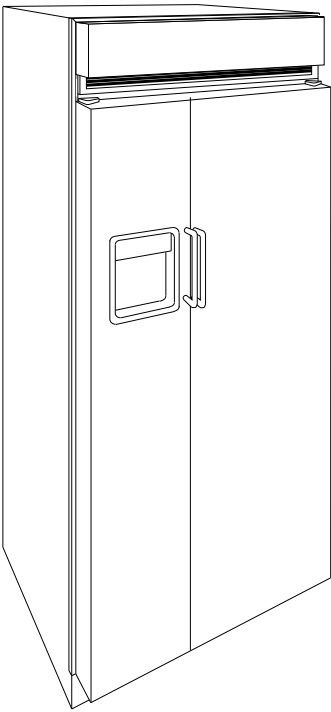

3/4" Custom
Trimless Panels With
Custom Handles:
Trim Kits ZKT36,
ZKHT1, ZWCD1

Monogram

Dimensions & Specifications

ZIS36NY 36" Built-In Refrigerator (non-dispenser)

Design Information

Designed to be installed flush with surrounding cabinetry. Cutout dimensions, clearances and side panel sizes are determined by the many installation options available. Side panels must be used whenever the sides of the refrigerator will be exposed. If custom enclosure has been made and installed, or if you are installing between pantry and oven cabinets, side panels are not required unless you are using frameless cabinets. IMPORTANT—Side panels, 1/2" min. thick, are required for FRAMELESS CABINETS.

- Field installed custom panels, Lexan® or stainless steel panels are required. Custom door panels and grille panel sizes vary to accommodate the kit being used.
- A custom toekick can be installed to match or complement the surrounding cabinetry. A standard toekick is supplied. For a custom toekick, use supplied toekick as a template to cut notches for hinges and water lines.

Optional Kits:

- ZWBP36: Black Lexan® Panel Kit (no trim kit required).
- ZWWP36: White Lexan® Panel Kit (no trim kit required).
- ZWSP36: Stainless Steel Panel Kit (no trim kit required).
- ZKH1: Provides for the installation of a custom handle on 1/4" custom panels.
- ZG1: Provides 1/4" grille panel frame side pieces for 83", 83-1/2" and 84-1/2" installation heights. Factory set height is 84".
- ZKT36: Provides for the installation of 3/4" custom door and grille panels.
- ZKHT1: Provides for the installation of a custom handle using 3/4" door and grille panels. (This kit must be used in conjunction with ZKT36.)

Additional Specifications

- A 115 volt 60 Hz., 15 or 20 amp power supply is required. An individual properly grounded branch circuit or circuit breaker is recommended. Install a properly grounded 3-prong electrical receptacle recessed into the back wall. Electrical must be located on rear wall.
- Water line can enter opening through the floor or back wall. The water line should be 1/4" O.D. copper tubing between the cold water line and water connection location, long enough to extend to the front of the refrigerator. Installation of an easily accessible shut off valve in the water line is recommended.

Clearances

If the refrigerator is to be installed in a corner:

- A 2" min. clearance between the case trim and adjacent wall on both sides of the refrigerator will assure a 90° door opening and access to all drawers. An 8" clearance is required on both sides for removal of pans.

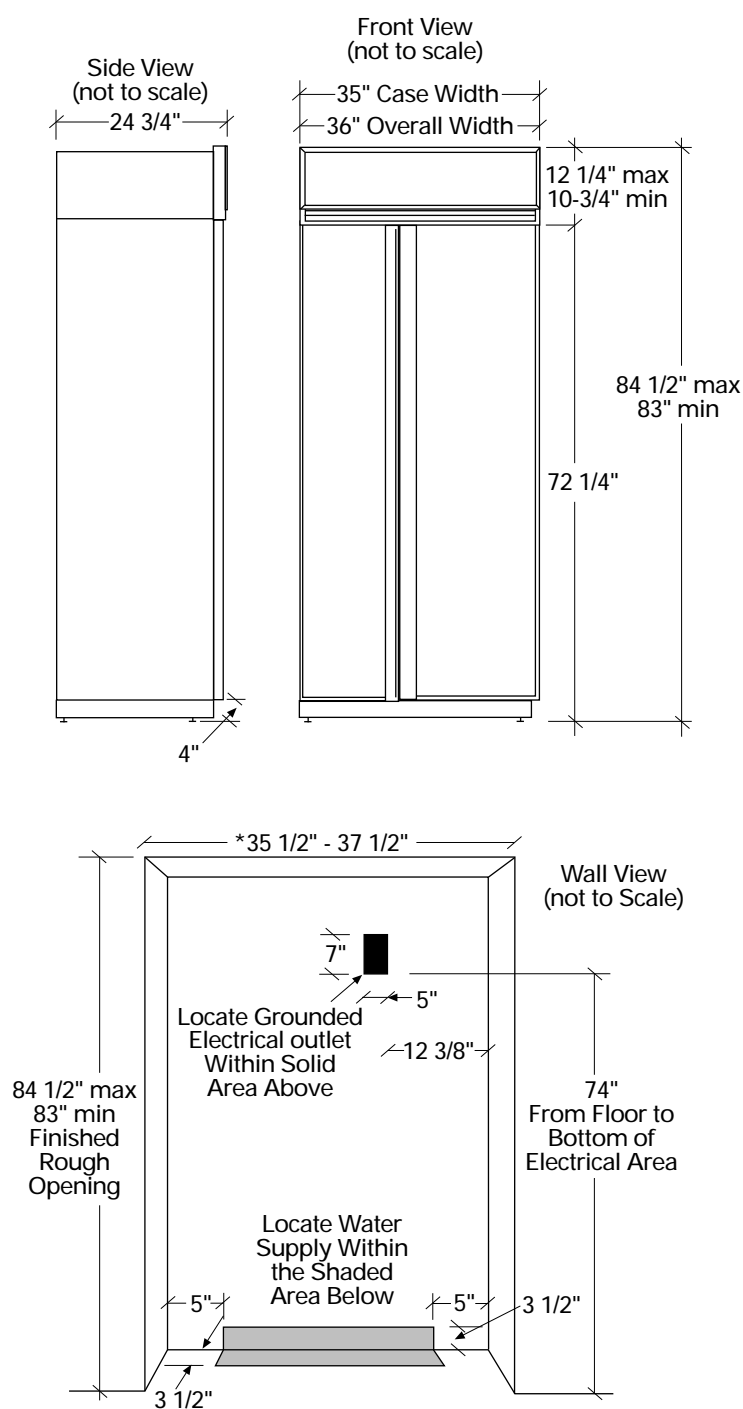

*The finished and rough-in dimensions are determined by the type of installation being made. The finished cutout width includes side panel thicknesses. See "Side Panel or Filler Options."

Monogram

Dimensions & Specifications

CUSTOM PANEL DIMENSIONS

Custom Door Panel Dimensions Using Standard Trim
1/4" thick panels
or
panels secured to 1/4" thick backing

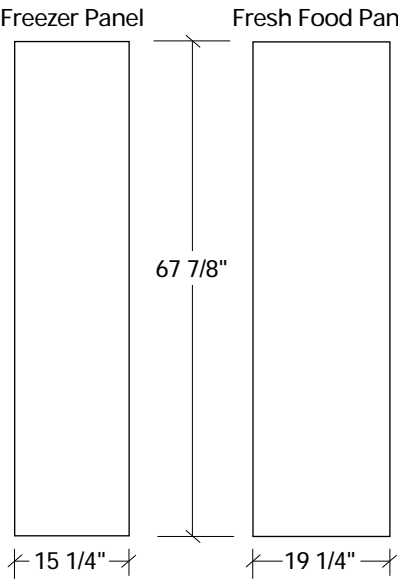

ZIS36NY
36" Built-In Refrigerator
(non-dispenser)

- Standard Trim with 1/4" Panels
- 1/4" Panels: Cut panels to size.
 - Custom handles with 1/4" door panels require Trim Kit ZKH1.

- Standard Trim with Panels secured to 1/4" thick backing
- Applying a raised panel design to a 1/4" thick backing (screwed or glued): Cut 1/4" panels to size, fabricate the raised panel to permit clearances of at least 2" from the handle side for fingertip clearance, 1-1/4" from the hinge side to avoid striking adjacent cabinetry and 5/16" from the top and bottom edges to allow for the trim flange then install.
 - Countertops adjacent to refrigerator installation should be mitered 45° degrees.

Note: ZKHT1 custom handle kit cannot be used in this configuration.

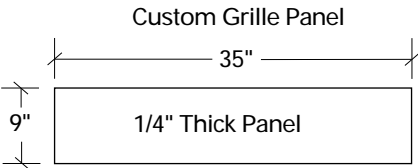
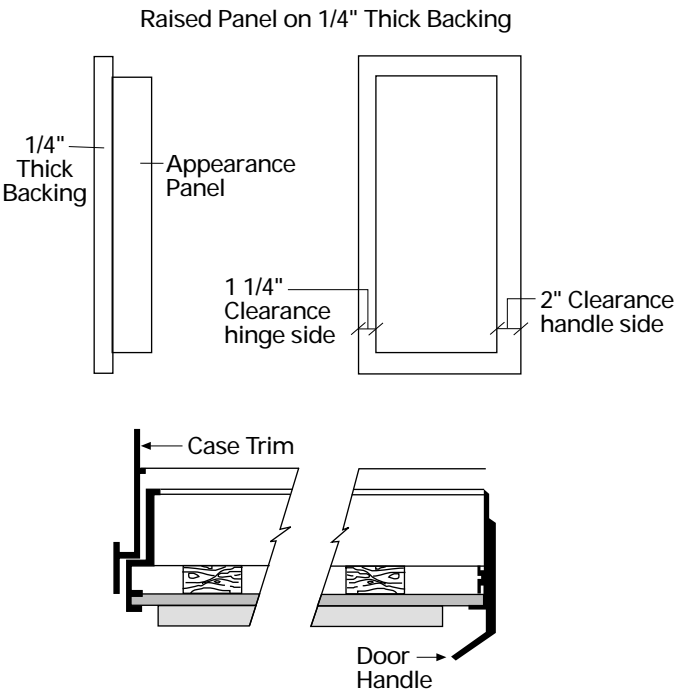

The grille panel frame is factory assembled for 84" installation height. If installation height varies, order ZG1 trim kit which provides optional side trim pieces. Cut custom, Lexan® or stainless panel to sizes shown below.

Installation Height	Panel Height
83"	8"
83-1/2"	8-1/2"
84-1/2"	9-1/2"

Important: Maintain 1-1/2" min. gap between top of doors and bottom of panel frame.

Monogram

*Dimensions &
Specifications*

Custom Door Panel Dimensions
Using Trim Kit ZKT36
3/4" thick panel with standard handle

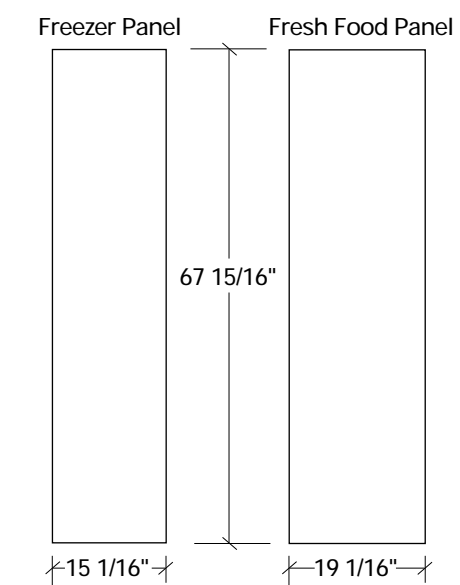

ZIS36NY
36" Built-In Refrigerator
(non-dispenser)

- The ZKT36 trim kit provides for the installation of 3/4" custom door and grille panels, using the standard full-length handle. Cut panels to size and install.

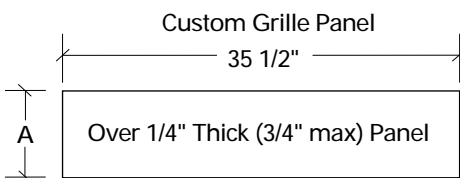

Grille Panel height can vary to fill installation height.

Installation Height	Dimension A
83"	8-1/4"
83-1/2"	8-3/4"
84"	9-1/4"
84-1/2"	9-3/4"

Important: Maintain 1-1/2" min. gap between top of doors and bottom of grille panel.

Monogram

Dimensions & Specifications

Custom Door Panel Dimensions
Using Trim Kits ZKT36 and ZKHT1
3/4" thick panel with custom handle

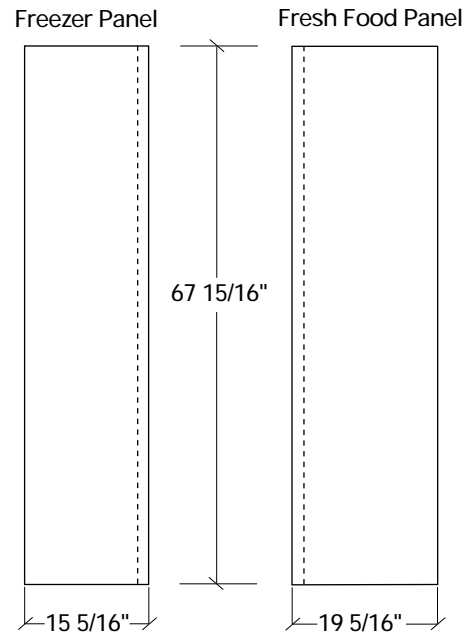

ZIS36NY
36" Built-In Refrigerator (non-dispenser)

- ZKT36 and ZKHT1 installed together provides for the installation of 3/4" custom door and grille panels, using a custom handle. Cut panels to size, rout the handle side of the panels as shown below and install.

CUSTOM PANEL
DIMENSIONS

Rout panels to specification below on the handle side of each panel

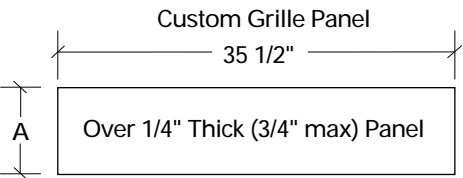
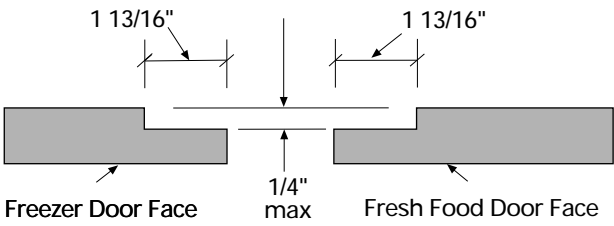

Grille Panel height can vary to fill installation height.

Installation Height	Dimension A
83"	8-1/4"
83-1/2"	8-3/4"
84"	9-1/4"
84-1/2"	9-3/4"

Important: Maintain 1-1/2" min. gap between top of doors and bottom of grille panel.

Monogram

Dimensions & Specifications

ZISW36DY (white dispenser)
ZISB36DY (black dispenser)
36" Built-In Refrigerator

Design Information

Designed to be installed flush with surrounding cabinetry. Cutout dimensions, clearances and side panel sizes are determined by the many installation options available. Side panels must be used whenever the sides of the refrigerator will be exposed. If custom enclosure has been made and installed, or if you are installing between pantry and oven cabinets, side panels are not required unless you are using frameless cabinets. **IMPORTANT**—Side panels, 1/2" min. thick, are required for **FRAMELESS CABINETS**.

- Field installed custom panels, Lexan® or stainless steel panels are required. Custom door panels and grille panel sizes vary to accommodate the kit being used.
- A custom toekick can be installed to match or complement the surrounding cabinetry. A standard toekick is supplied. For a custom toekick, use supplied toekick as a template to cut notches for hinges and water lines.

Optional Kits:

- ZWBP36D: Black Lexan® Panel Kit (no trim kit required).
- ZWWP36D: White Lexan® Panel Kit (no trim kit required).
- ZWSP36D: Stainless Steel Panel Kit (no trim kit required).
- ZKH1: Provides for the installation of a custom handle on 1/4" custom panels.
- ZG1: Provides 1/4" grille panel frame side pieces for 83", 83-1/2" and 84-1/2" installation heights. Factory set height is 84".
- ZKT36: Provides for the installation of 3/4" custom door and grille panels.
- ZKHT1: Provides for the installation of a custom handle using 3/4" door and grille panels. (This kit must be used in conjunction with ZKT36.)
- ZWCD1: Provides for the installation of a custom collar trim on the dispenser for one continuous custom panel on the freezer door. This kit can be used alone, or with one or more trim kits.

Additional Specifications

- A 115 volt 60 Hz., 15 or 20 amp power supply is required. An individual properly grounded branch circuit or circuit breaker is recommended. Install a properly grounded 3-prong electrical receptacle recessed into the back wall. Electrical must be located on rear wall.
- Water line can enter opening through the floor or back wall. The water line should be 1/4" O.D. copper tubing between the cold water line and water connection location, long enough to extend to the front of the refrigerator. Installation of an easily accessible shut off valve in the water line is recommended.

Clearances

If the refrigerator is to be installed in a corner:

- A 2" min. clearance between the case trim and adjacent wall on both sides of the refrigerator will assure a 90° door opening and access to all drawers. An 8" clearance is required on both sides for removal of pans.

CUSTOM PANEL DIMENSIONS

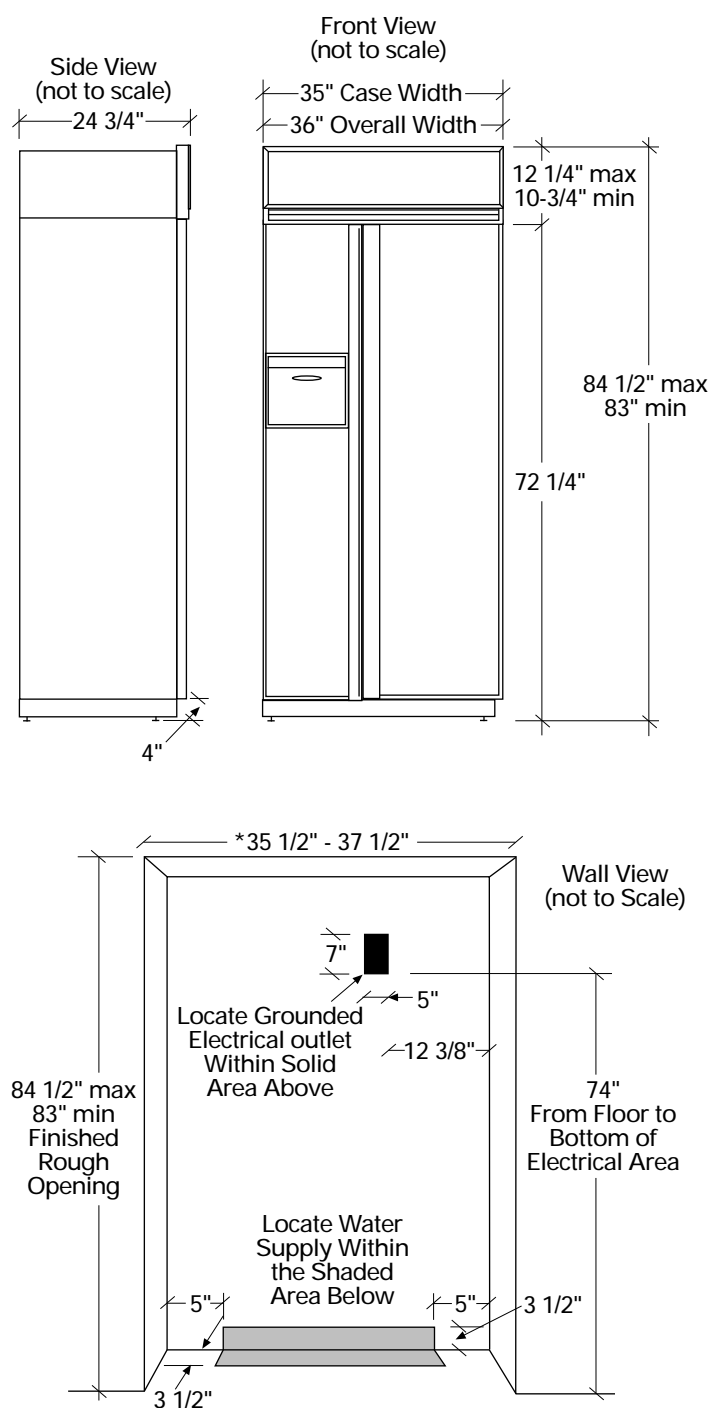

*The finished and rough-in dimensions are determined by the type of installation being made. The finished cutout width includes side panel thicknesses. See "Side Panel or Filler Options."

Monogram

Dimensions & Specifications

CUSTOM PANEL DIMENSIONS

Custom Door Panel Dimensions Using Standard Trim
1/4" thick panels
or
Panels secured to 1/4" thick backing

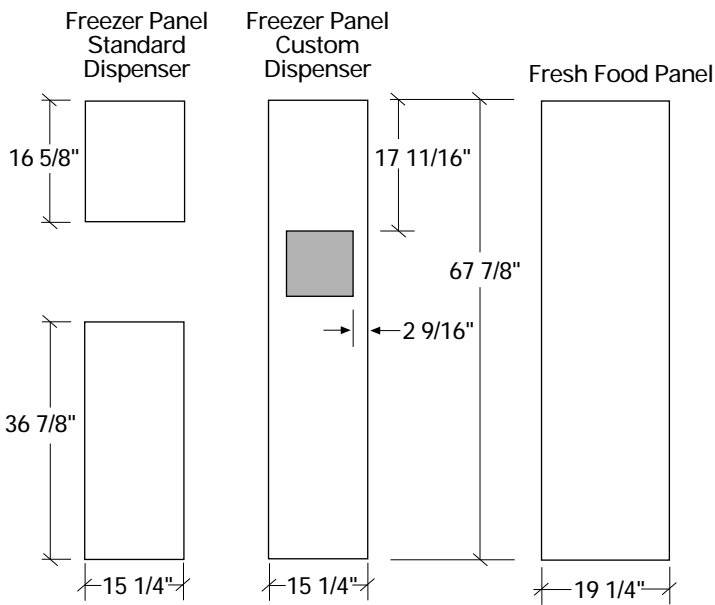

ZISW36DY (white dispenser)
ZISB36DY (black dispenser)
36" Built-In Refrigerator

- Standard Trim with 1/4" Panels
- 1/4" Panels: Cut panels to size.
 - Custom handles with 1/4" door panels require Trim Kit ZKH1. When using ZKH1 with the standard dispenser trim, the length of the custom handle, top to bottom cannot exceed 11-3/4".
 - Custom collar dispenser trim with 1/4" door panels require trim kit ZWCD1.

- Standard Trim with Panels secured to 1/4" thick backing
- Applying a raised panel design to a 1/4" thick backing (screwed or glued): Cut 1/4" panels to size, fabricate the raised panel to permit clearances of at least 2" from the handle side for fingertip clearance, 1-1/4" from the hinge side to avoid striking adjacent cabinetry and 5/16" from the top and bottom edges to allow for the trim flange, then install.
 - Countertops adjacent to refrigerator installation should be mitered 45° degrees.

Note: ZWCD1 custom collar dispenser trim and ZKHT1 custom handle kits cannot be used in this configuration.

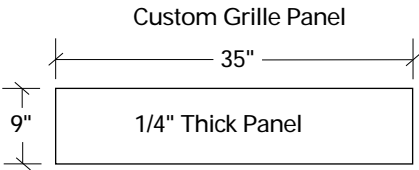
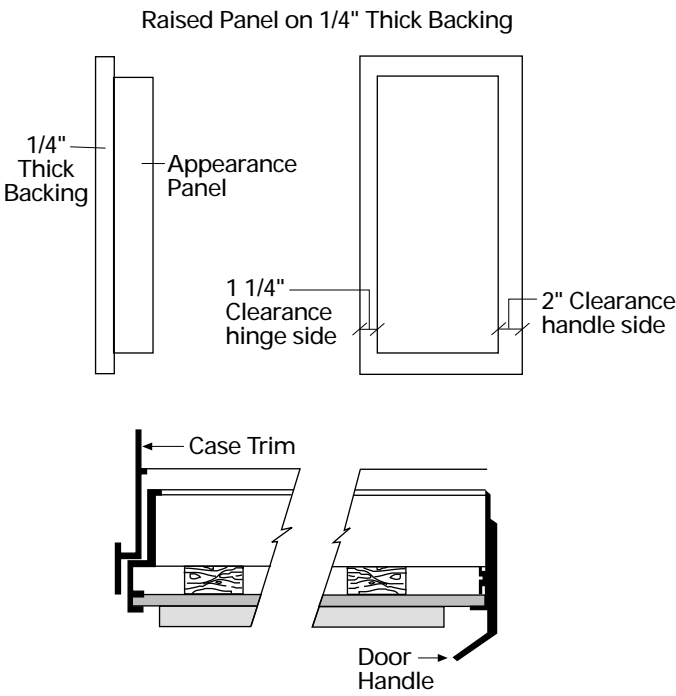

The grille panel frame is factory assembled for 84" installation height. If installation height varies, order ZG1 trim kit which provides optional side trim pieces. Cut custom, Lexan® or stainless panel to sizes shown below.

Installation Height	Panel Height
83"	8"
83-1/2"	8-1/2"
84-1/2"	9-1/2"

Important: Maintain 1-1/2" min. gap between top of doors and bottom of panel frame.

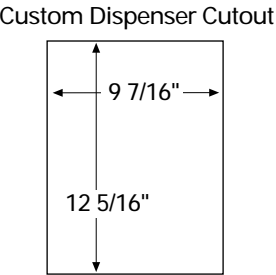

The Cutout is 9 7/16" wide by 12 5/16" high.

Custom Door Panel Dimensions
Using Trim Kit ZKT36
3/4" thick panel with standard handle
and/or ZWCD1 custom collar trim

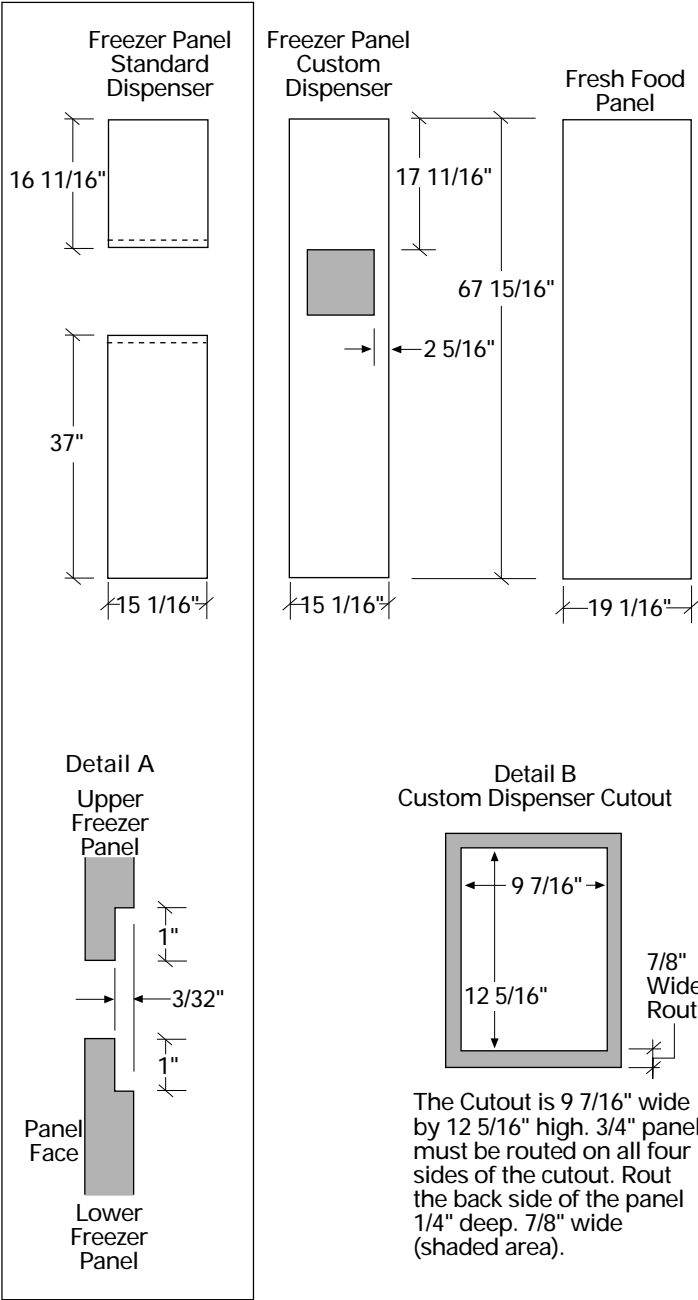

Monogram

Dimensions &
Specifications

ZISW36DY (white dispenser)
ZISB36DY (black dispenser)
36" Built-In Refrigerator

- The ZKT36 trim kit provides for the installation of 3/4" custom door and grille panels, using the standard full-length handle. Cut panels to size and install.
- For standard dispenser trim: Cut panels to size, rout the bottom of the upper freezer panel and the top of the lower freezer panel to allow placement of support brackets and install (see detail A).
- For custom dispenser trim ZWCD1 kit must be used: Cut panels to size, refer to detail B for dispenser cutout routing instructions and install. When a raised panel design is used, custom width stiles and custom middle rail is required. A 13-1/2" wide middle rail must be used because the custom collar trim must be located within the raised portion of the panel. This area must be 3/4" thick. See Detail C for raised panel.

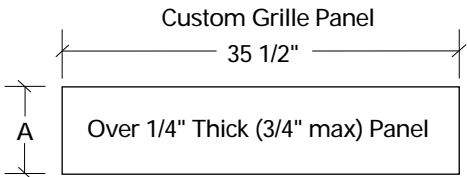

Grille Panel height can vary to fill installation height.

Installation Height	Dimension A
83"	8-1/4"
83-1/2"	8-3/4"
84"	9-1/4"
84-1/2"	9-3/4"

Important: Maintain 1-1/2" min. gap between top of doors and bottom of grille panel.

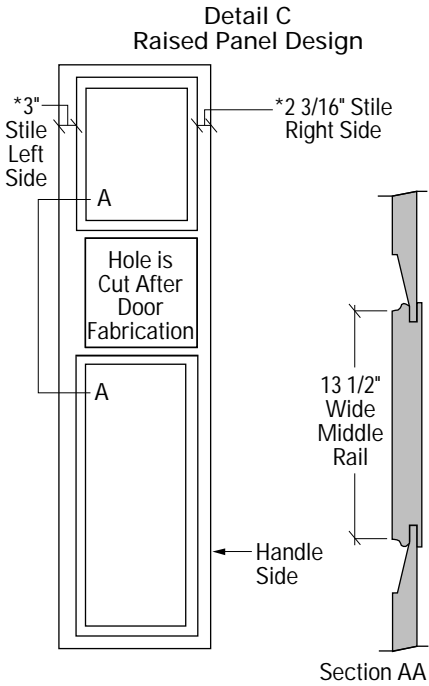

Monogram

Dimensions & Specifications

Custom Door Panel Dimensions
Using Trim Kit ZKT36 and ZKHT1
3/4" thick panel with custom handle
and/or ZWCD1 custom collar trim

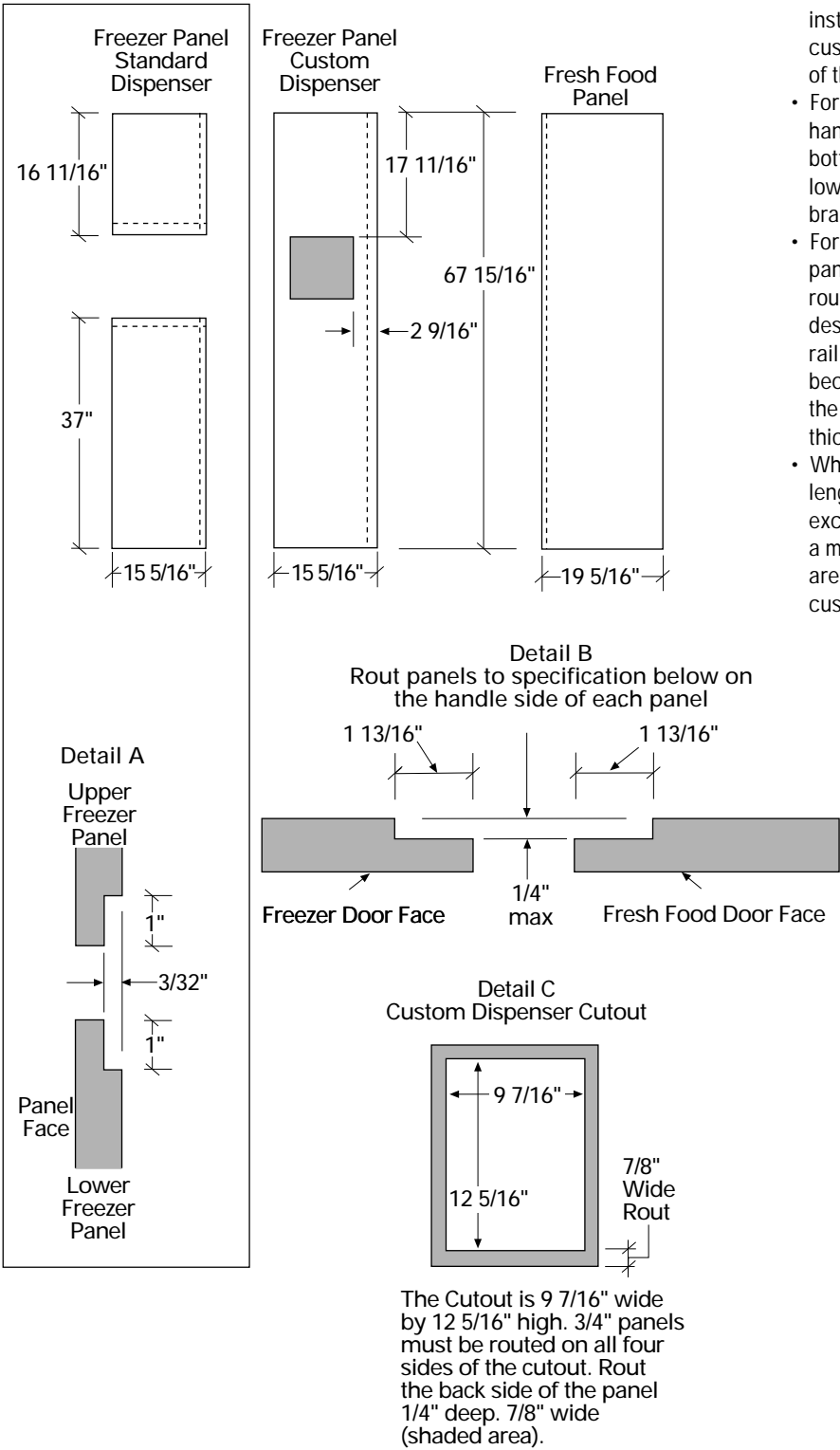

ZISW36DY (white dispenser)
ZISB36DY (black dispenser)
36" Built-In Refrigerator

- ZKT36 and ZKHT1 installed together provides for the installation of 3/4" custom door and grille panels, using a custom handle. Cut panels to size, rout the handle side of the panels as shown below and install (see detail B).
- For standard dispenser trim: Cut panels to size, rout the handle side of the panels as shown in detail B, rout the bottom of the upper freezer panel and the top of the lower freezer panel to allow placement of support brackets (see detail A) and install.
- For custom dispenser trim ZWCD1 kit must be used: Cut panels to size, refer to detail C for dispenser cutout routing instructions and install. When a raised panel design is used, custom width stiles and custom middle rail is required. A 13-1/2" wide middle rail must be used because the custom collar trim must be located within the raised portion of the panel. This area must be 3/4" thick. See Detail D for raised panel.
- When using the standard full-width dispenser trim, the length of the custom handle, top to bottom cannot exceed 11-3/4". Locate the handle a minimum of 3/4" and a maximum of 1-1/2" from the edge of the panel. There are no length restrictions on handles for models using a custom collar dispenser trim (ZWCD1).

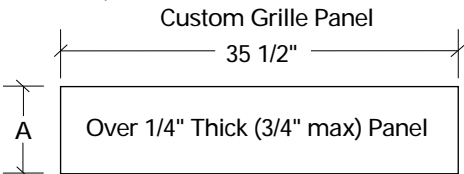

Grille Panel height can vary to fill installation height.

Installation Height	Dimension A
83"	8-1/4"
83-1/2"	8-3/4"
84"	9-1/4"
84-1/2"	9-3/4"

Important: Maintain 1-1/2" min. gap between top of doors and bottom of grille panel.

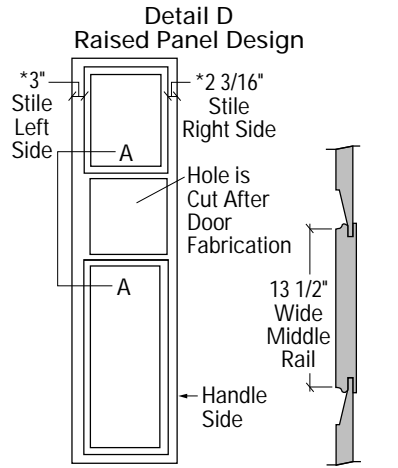

CUSTOM PANEL
DIMENSIONS

Monogram

Dimensions & Specifications

Side Panel or Filler Options (not to scale)

Side panels must be used whenever the sides of the refrigerator will be exposed.

SIDE PANEL DIMENSIONS

1/4" Side Panels
Insert end of side panel into trim.

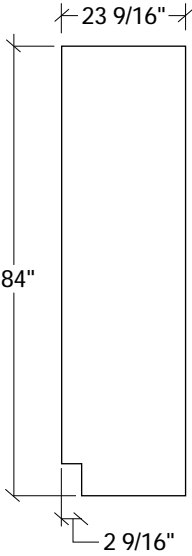
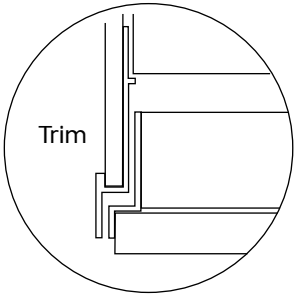

Standard 4" high toekick or trim to fit.
Height may vary depending on application.

1/2" to 3/4" Side Panels
Leading Edge
Flush with Cabinet
Front.

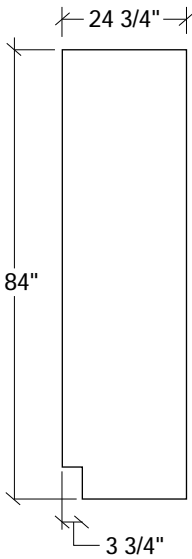
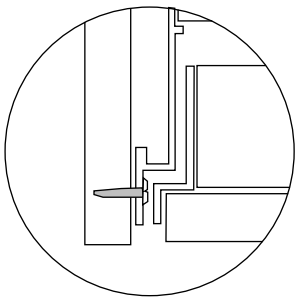

Standard 4" high toekick or trim to fit.
Height may vary depending on application.

1/2" to 3/4" Side Panels
Recessed front edge.

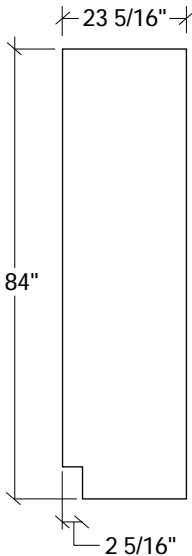
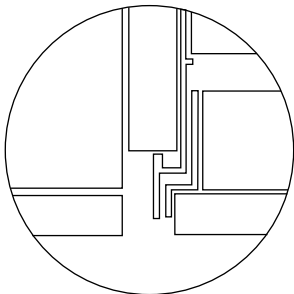

Standard 4" high toekick or trim to fit.
Height may vary depending on application.

1/2" to 3/4" Side Panels
Leading edge routed
1/4" deep, 1-1/2" top to
bottom.

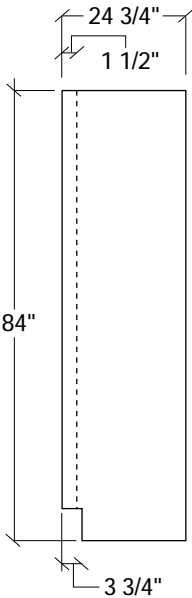
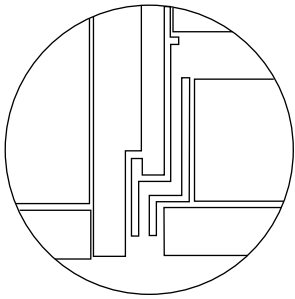

Standard 4" high toekick or trim to fit.
Height may vary depending on application.

Installation

36" Built-In Refrigerator

Before you begin – Read these instructions completely and carefully.
IMPORTANT – Save these instructions for local inspector's use.
IMPORTANT – OBSERVE ALL GOVERNING CODES AND ORDINANCES.
Note to Installer – Be sure to leave these instructions with the Consumer.
Note to Consumer – Keep these instructions with your Use and Care Book for future reference.

Step 1 Remove packaging

- CAUTION: Refrigerator is much heavier at the top than at the bottom—be careful when moving.
- Remove outer carton.
 - Carefully cut banding at top and bottom.
 - Remove top cap.
 - Slide out back corner posts (2).
 - Slide carton off top of cabinet.
 - Remove toekick from back of refrigerator and set aside for later installation.
 - Remove grille panel frame from front of door, set aside for later installation.
- NOTE: IT IS NOT NECESSARY TO LAY CABINET DOWN IN ORDER TO REMOVE SKID!
- To remove skid, remove the four 7/16" bolts and their brackets.
- CAUTION: DO NOT ATTEMPT TO ROLL UNIT OFF SKID.
- There are support blocks on the bottom of cabinet and door. They must be removed before rolling unit off skid or damage will occur.
 - Carefully tilt cabinet and slide blocks out from underneath cabinet, slide unit off skid.
- When using a hand-truck, handle from side only.

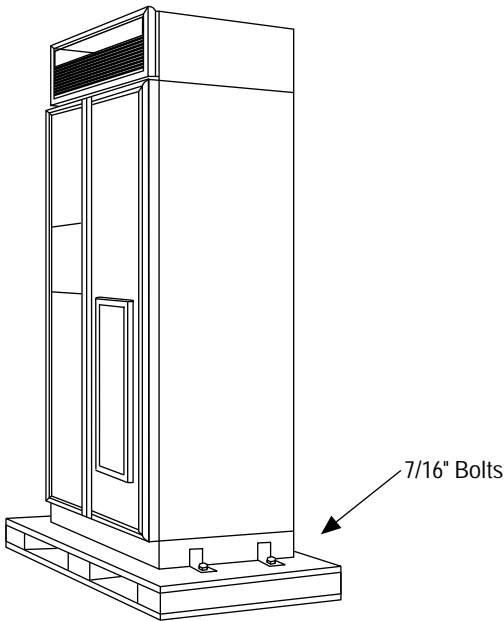

Caution: Refrigerators are much heavier at the top than at the bottom—be extra careful when moving.

PRODUCT
INSTALLATION

Step 2 Prepare water line

- Route 1/4" OD copper tubing between house cold water line and the water connection location.
- Copper tubing should be long enough to extend to the front of the refrigerator. Allow enough to accomodate bend leading into the water valve.
- Install a shut-off valve between the icemaker water valve and cold water pipe in the basement or a cabinet. The shut-off valve should be located where it will be easily accessible.

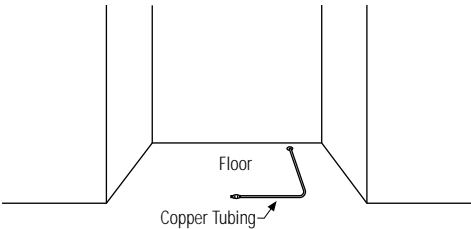

Step 3 Grounding the appliance

IMPORTANT—(Please read carefully)
FOR PERSONAL SAFETY, THIS APPLIANCE MUST BE PROPERLY GROUNDED.
The power cord of this appliance is equipped with a three-prong (grounding) plug which mates with a standard three-prong grounding wall receptacle to minimize the possibility of electric shock hazard from this appliance.
If the electrical service provided does not meet the above specifications, it is recommended that a licensed electrician install an approved outlet.

DO NOT, UNDER ANY CIRCUMSTANCES, CUT OR REMOVE THE THIRD (GROUND) PRONG FROM THE POWER CORD.
DO NOT USE AN EXTENSION CORD WITH THIS APPLIANCE.
DO NOT USE AN ADAPTOR PLUG WITH THIS APPLIANCE.

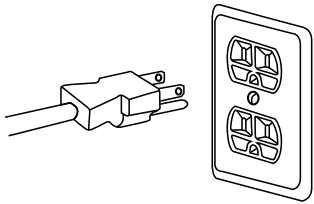

Installation

36" Built-In Refrigerator

Tools
required

- Tinsnips to cut banding
 - Stepladder
- Bucket
 - Level
 - Appliance Hand Truck
 - Tubing cutter
- 7/16" open-end wrench
 - #2 Phillips screwdriver
 - Stubby Phillips screwdriver
- Drill and appropriate bits
 - 7/16" socket with 3" extension for ratchet
 - Safety glasses

Hardware
supplied

- 1-1/2" stamped open-end wrench
- Special plastic fastener adhesive strips
- 1/4" panel foam spacers
 - 1/4 -1/4 union with nuts

Hardware
required

- Water shut-off valve (optional but recommended)
- Water filter WR97X0214 (optional but recommended)
- Custom panel for fresh food and freezer compartments
- Side panels (see page 14)
 - Hardware for side panel installation

Flooring

For proper installation, this unit must be placed on a level surface of hard material that is at the same height as the rest of the flooring. This surface should be strong enough to support a fully loaded refrigerator.

CAUTION: Protect the finish of the flooring. Cut a large section of the cardboard carton, lay on the floor in the area where you are working.

Cutout
information

Monogram refrigerators offer many installation options. The finished and rough-in dimensions are determined by the type of installation being made. See Cutout Dimensions on page 6 or 10 and “Side Panel or Filler Options” on page 14.

Install
side panels

Side panels are normally set into place and fastened to adjacent cabinetry. See “Side Panel or Filler Options” on page 14.

Step 4
Roll unit
into opening

With cardboard protective pad in position, use a handtruck to roll refrigerator into the front of the location cut-out.

Step 5
Level
refrigerator

- All models have 4-point leveling. The front is supported by leveling legs, the back is supported by rear wheels.
- To level the back of the unit, turn the 7/16" hex nut located above the front wheels.
 - For front leveling, use the 1-1/2" open-end wrench (provided).
 - Turn hex nut or front leveling leg to raise or lower the refrigerator.
 - Adjust carefully, the refrigerator should be level and plumb with cabinetry, and should align with toekick height.

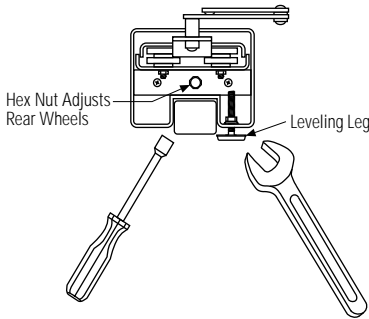

Installation

36" Built-In Refrigerator

Step 6
Install 1/4" door panels

If you are using 3/4" thick custom panels, see pages 8, 9, 12 or 13 for panel sizes with ZKT trim kit and/or custom handles. Order the appropriate trim kit to suit the appearance option.

If you are using the custom collar dispenser trim, order ZWCD1 trim kit.

To install 1/4" door panels:

- Carefully remove the Phillips head screws from the door handle endcaps, top and bottom.
- Open door to 90° stop. Remove the Phillips head screws from the aluminum trim door handles. Retain all screws.

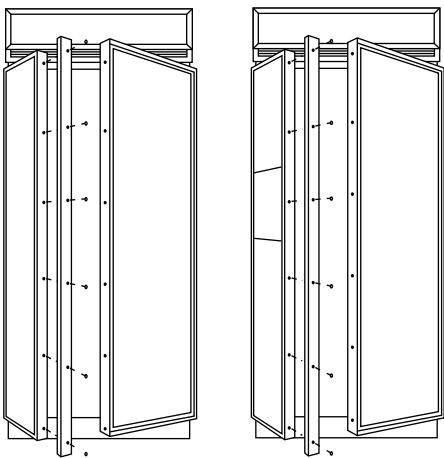

- Attach 2" x 2" adhesive backed foam pads to the door. These fillers assure proper fit. Fillers are shipped with literature package in snack pack drawer.

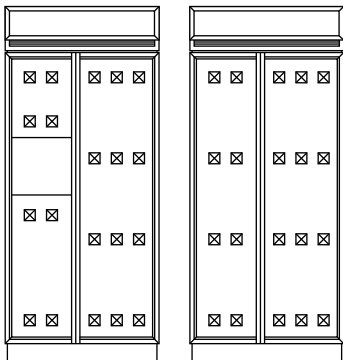

- Slide in panels.
- Replace door handles and secure with original screws.
- Again, check to be sure unit is level and that panels align with cabinetry. Doors will not close properly if unit is not level.
- Check for noises caused by incomplete alignment (rubbing of panels, trim or screws).

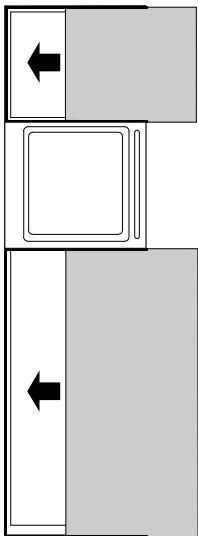
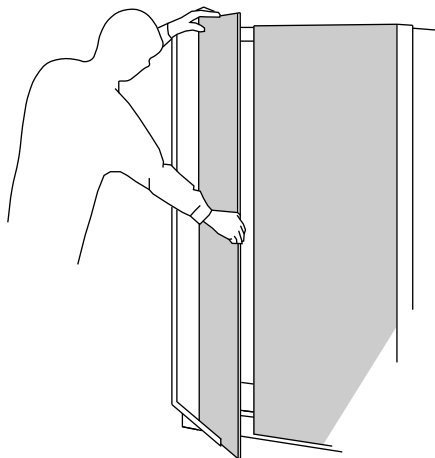

PRODUCT
INSTALLATION

Step 7
Connect power

- Connect refrigerator power cord plug to properly grounded receptacle, accessible through the top right side of the hood opening.
- Check to make sure power to refrigerator is on by opening refrigerator door to see if interior lights are on.

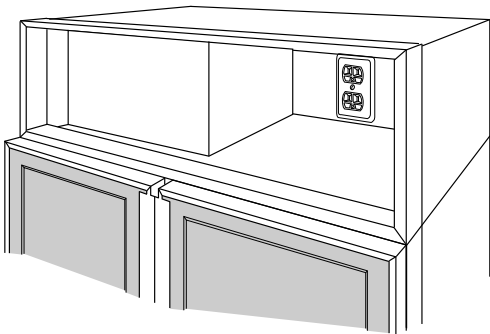

Installation

36" Built-In Refrigerator

WARNING

Anti-tip
precautions

Personal Injury/Property Damage Hazard

The refrigerator is much heavier at the top. To prevent the refrigerator from tipping over you must:

- Install a wood block, the full width of the refrigerator. Secure the block with wood screws penetrating at least 3/4" into wall studs.

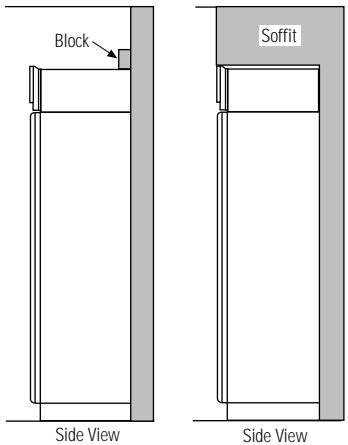

Step 8
Secure
refrigerator
case trim
to side panel

When using 1/2" to 3/4" side panels, the front flange of the case trim is attached to the side panel.

- Open freezer door to access case trim.
- Drill hole in flange and drive screw through the flange, into the side panel.
- Follow the same procedure for fresh food side.

OR

If refrigerator is installed between cabinets with no side panels or in a custom enclosure, install a spacer block as shown.

- Open freezer door to access case trim.
- Drill hole in trim and drive screw through the trim and into the spacer block.
- Follow the same procedure for fresh food side.

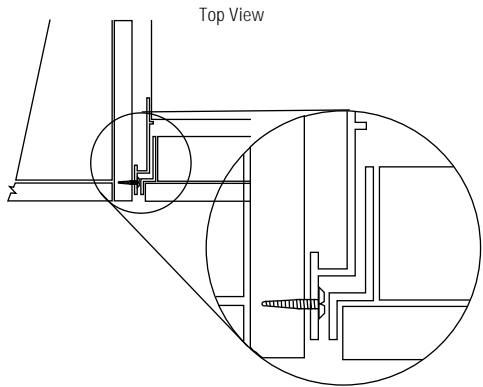
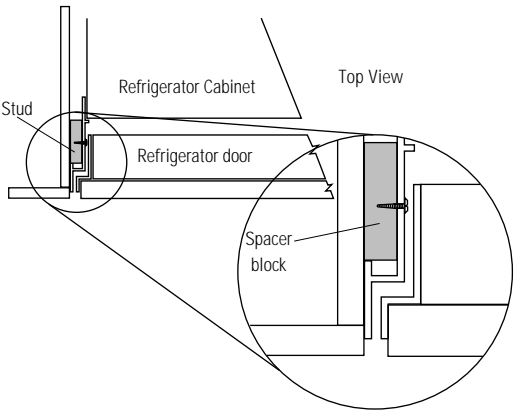

Step 9
Connect
water
supply

- Locate and bring copper tubing to front of cabinet.
- Turn water on to flush debris from line, run about a quart of water through tubing into a bucket, then shut off water.
- Slip a 1/4-1/4 union nut (provided) over both ends of the copper tubing at the right front leg of the refrigerator and couple the lines.
- Turn on water to check for leaks.

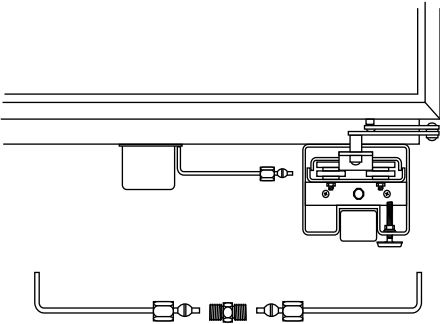

Installation

36" Built-In Refrigerator

Step 10
Mount 1/4" top grille panel

If you are using 3/4" thick custom panels, SKIP THIS STEP. See page 12 for grille panel sizes. Order the ZKT kit, and follow the installation instructions packed with the kit.

The grille panel frame is factory assembled for 84" installation height. If installation height varies, order ZG1 trim kit which provides optional side trim pieces. Cut custom, Lexan® or stainless panel to sizes shown below.

Models	Installation Height	Panel Height	Panel Width
36" wide	83"	8"	35"

- The grille panel frame for the top grille is shipped with the unit.
- The refrigerator is shipped with the top case trim secured at the 83" refrigerator height.
- Loosen 2 screws on both sides and raise the case trim to meet soffit height, from 83" to 84-1/2".
 - Tighten all 4 screws.
- To insert decorative grille panel into the frame:
- Remove 2 screws (one each in top corners) as shown.
 - Slide panel into the frame and reassemble.
 - Mount panel grille by dropping into the slots on the case trim.

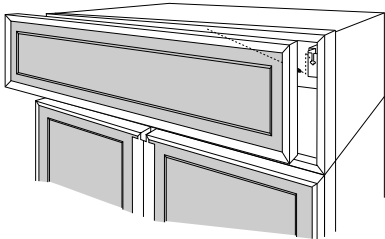

Important: Maintain 1-1/2" min. gap between top of doors and bottom of panel frame.

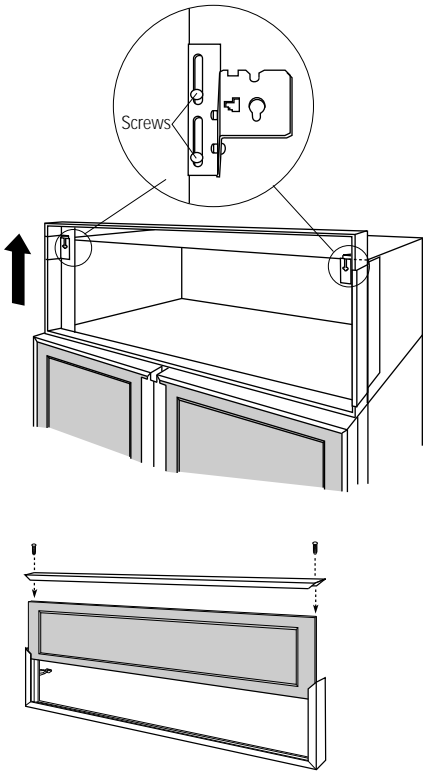
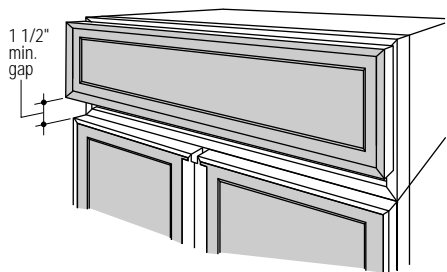

PRODUCT
INSTALLATION

Step 11
Install toekick

- A custom toekick can be installed to match or complement the surrounding cabinetry.
- A standard toekick is supplied with all refrigerators. If a custom toekick is to be installed, use the supplied toekick as a template to cut out notches around hinges and water line tubing.
- For 1/2" to 3/4" thick custom toekicks, additional material should be removed and cut away. This will allow the water and electrical umbilical tube to rotate smoothly when the door is fully opened.
- The custom toekick should be installed in such a manner that it can be removed if service is required.

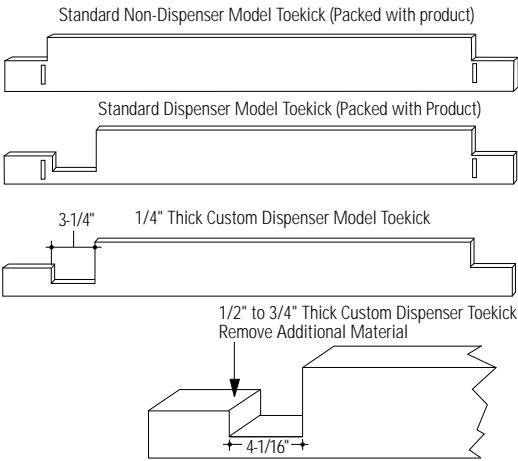

Kit contents

ZKH1 Trim Kit

Custom Handles with 1/4" Panels

Tools and materials required:

- #2 Phillips screwdriver
- Drill and appropriate bits
- Custom door panels
- Custom handles
- Safety glasses

These instructions are divided into 2 options:
Option 1—For non-dispenser and dispenser models using custom collar trim.
Option 2—For dispenser model using the standard full-width trim.

Parts List:

- A. Fresh food door extrusion
- B. Freezer door extrusion for non-dispenser model and dispenser model using custom collar. (Option 1)
- C. Freezer door extrusion for dispenser model using full-width trim. (Option 2)
- D. Handle bracket for dispenser model using full-width trim. (Option 2)

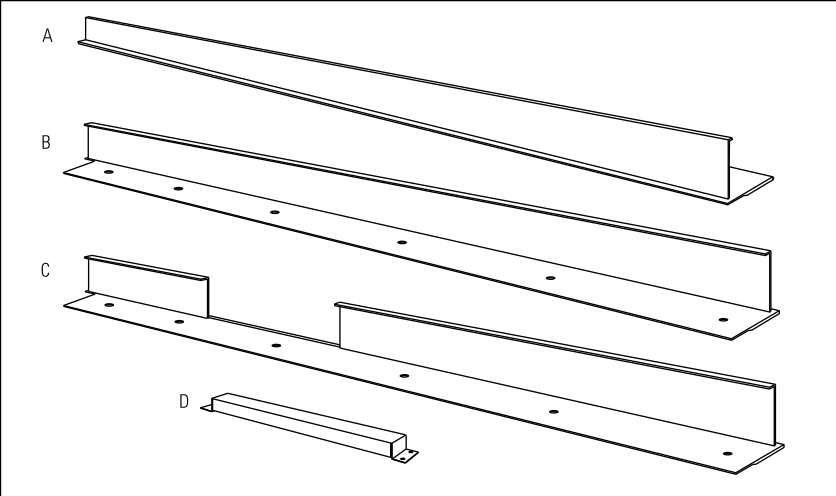

This kit provides for the installation of custom handles on 1/4" thick decorator door panels. The door extrusions and bracket allow custom handles to be secured to the door structure, rather than the door panels. This kit contains all the necessary parts for dispenser and non-dispenser models. Follow the instructions for Option 1

when applying custom handles to a non-dispenser model or dispenser model using custom collar trim. Follow instructions in Option 2 for a dispenser model using the standard full-width dispenser trim.

OPTION 1
For non-dispenser model or dispenser model using custom collar trim

Step 1
Remove handles

- Carefully remove the Phillips head screws from the door handle endcaps, top and bottom.
- Open doors to 90°. Remove the screws from the full-length aluminum handles of both doors.
- Retain screws, discard handles and endcaps.

Note: If a custom collar is to be used, order ZWCD1 Trim Kit.

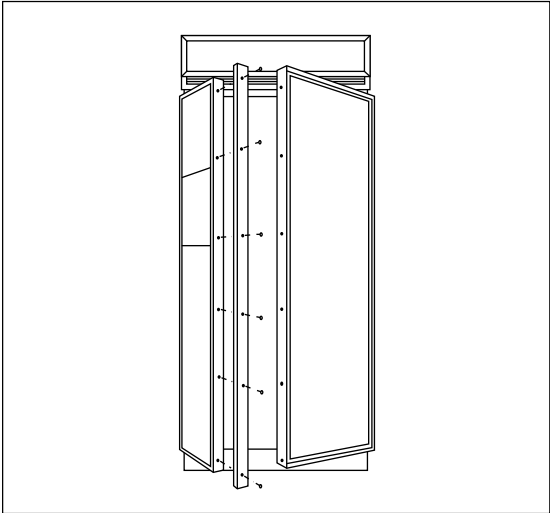

ZKH1 Trim Kit

Custom Handles with 1/4" Panels

Option 1 Installation

Step 2
Locate position
of handles

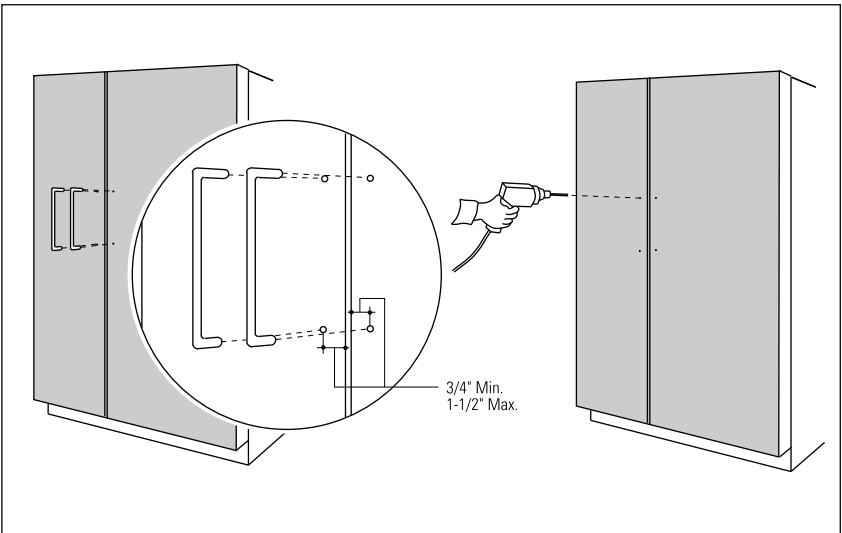
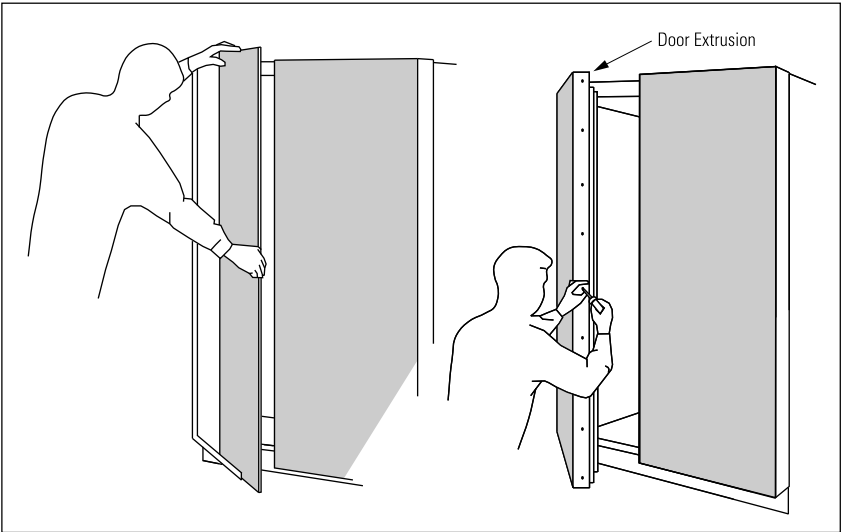

Note: Handle must be located 3/4" to 1-1/2" from edge of extrusion.

- Slide custom panels into fresh food and freezer door frames.
- Temporarily secure the new door extrusions to the doors. Use at least 2 screws on each door.
- The handles must be located 3/4" to 1-1/2" from the edge of the extrusion.
- Determine the desired location of the custom handles and carefully mark centerlines of the screw holes.
- Again, with both doors closed, check the location of the centerlines to be sure they are parallel to the edge of the door, and level with opposite door.
- Drill 1/16" pilot hole through the panel until it starts into the aluminum extrusion. This will mark the matching location for drilling the clearance hole when assembling the handle, panel and extrusion.

ZKH1 INSTALLATION
INSTRUCTIONS

ZKH1 Trim Kit

Custom Handles with 1/4" Panels

Option 1 Installation

Step 3
Assemble panel,
extrusion and
handle

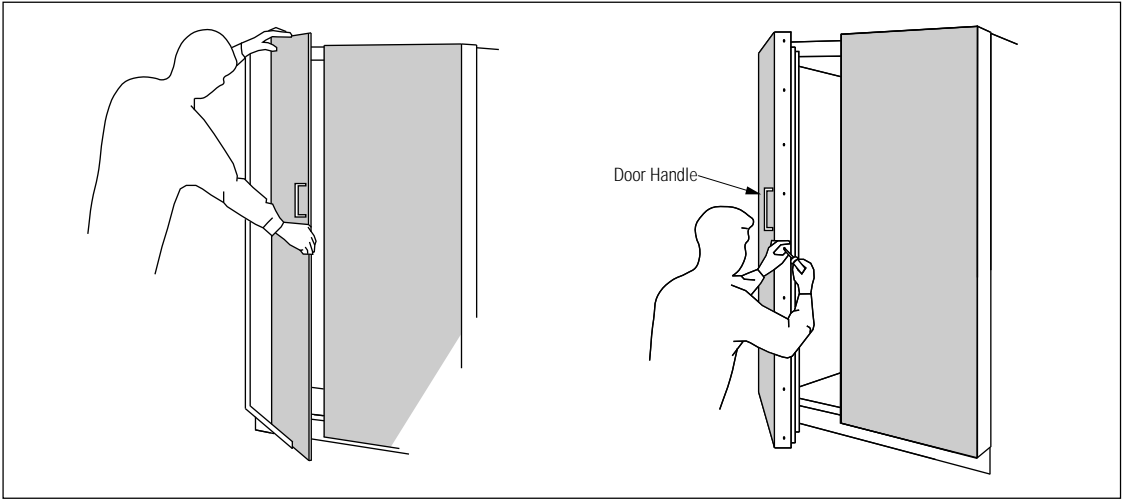
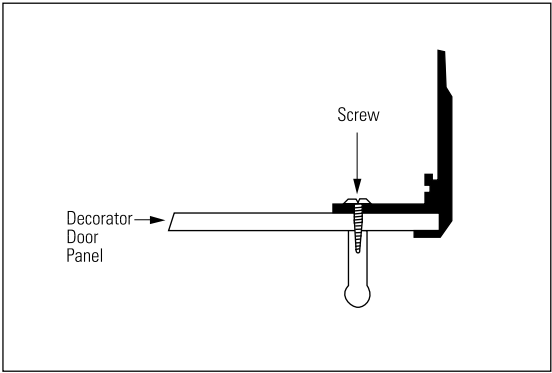
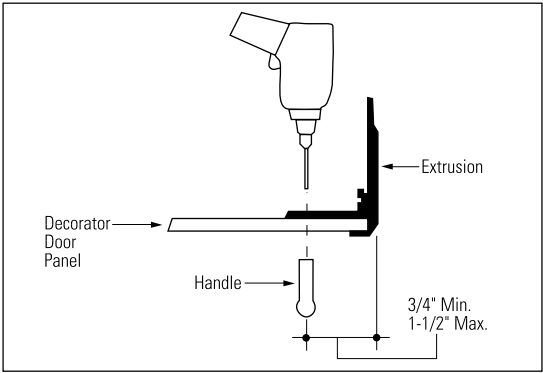

- Remove the door extrusions and door panels.
- Drill 1/16" pilot hole through extrusion.
- Drill clearance holes through the panel and extrusion.
- Assemble the door panel, extrusion and custom handle.
- Install screw(s) long enough to pass through the extrusion, door panel and into the handle.
- Slide the assembly into the door frame until the new extrusion fits firmly against the steel door.
- Re-install original screws into the door extrusion.

ZKH1 Trim Kit

Custom Handles with 1/4" Panels

OPTION 2
For dispenser model
using full-width
trim

Step 1
Remove handles

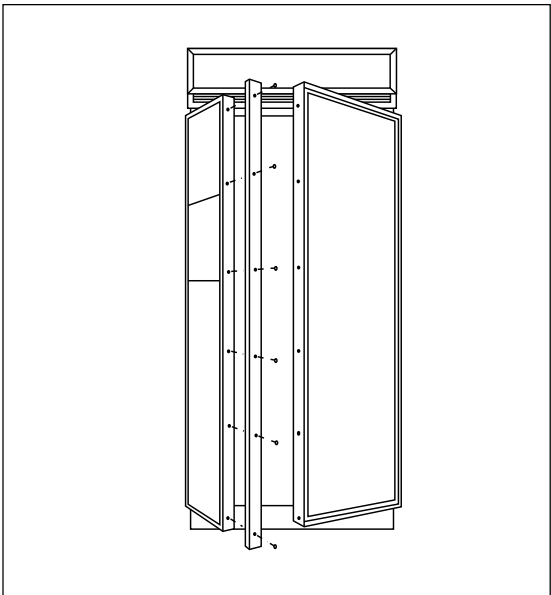

- Carefully remove the Phillips head screws from the door handle endcaps, top and bottom.
- Open door to 90°. Remove the screws from the full-length aluminum handle of the freezer door.
- Retain screws, discard handle and endcaps.

ZKH1 INSTALLATION
INSTRUCTIONS

Step 2
Remove trim

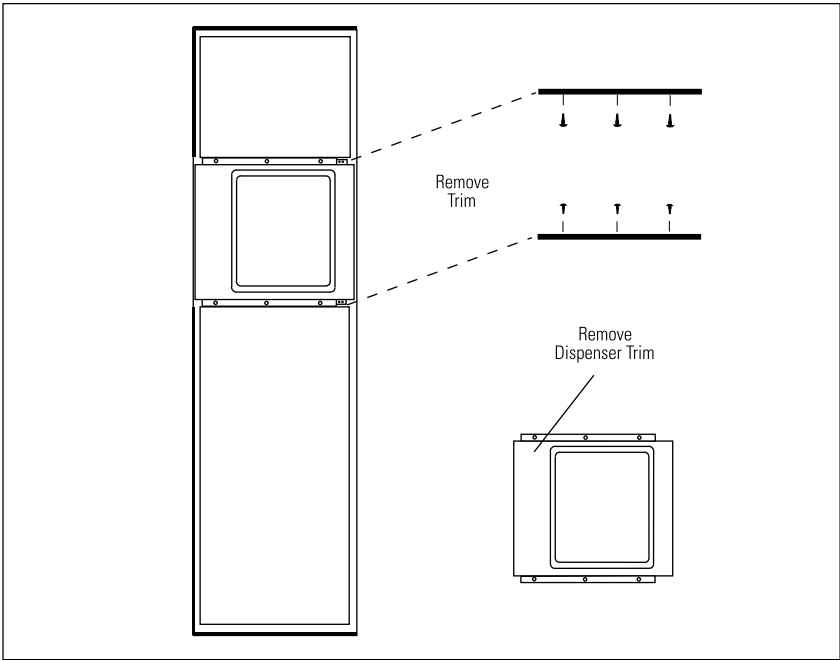

Remove door panel trim above and below dispenser. Lift off dispenser trim. Retain screws and trim.

Step 3
Locate
position
of handle

ZKH1 Trim Kit

Custom Handles with 1/4" Panels

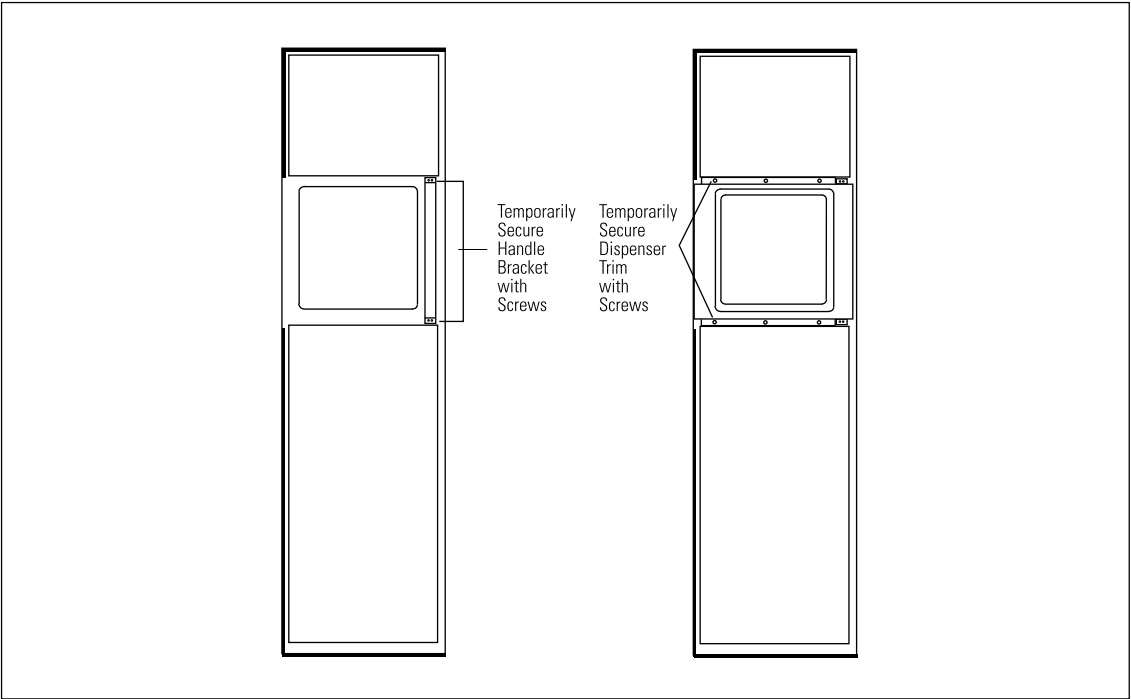

- Position the handle bracket onto the steel door by matching existing screw holes on the door and bracket. Temporary secure with screws.
- Re-install dispenser trim, temporarily.
- Determine the desired location of the custom handle and carefully mark centerlines of the screw holes.
- Drill 1/16" pilot hole through the trim until it starts into the handle bracket. This will mark the matching location for drilling a clearance hole when assembling the handle, bracket and dispenser trim.
- Remove dispenser trim and bracket.

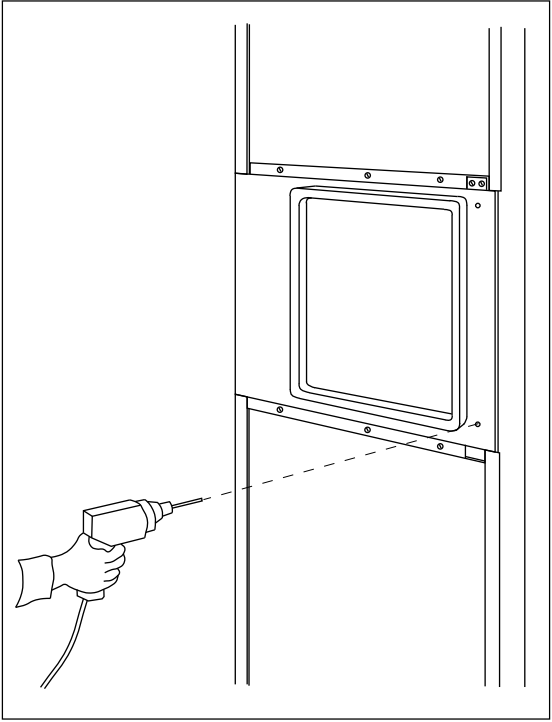

ZKH1 Trim Kit

Custom Handles with 1/4" Panels

Option 2 Installation

Step 4 Install custom handle

- Drill clearance holes through the handle bracket and the dispenser trim.
- Install screw(s) long enough to pass through the handle bracket, dispenser trim and into the custom handle.

Note: The custom handle must be installed against the handle bracket. The custom handle cannot exceed 11-3/4" length.

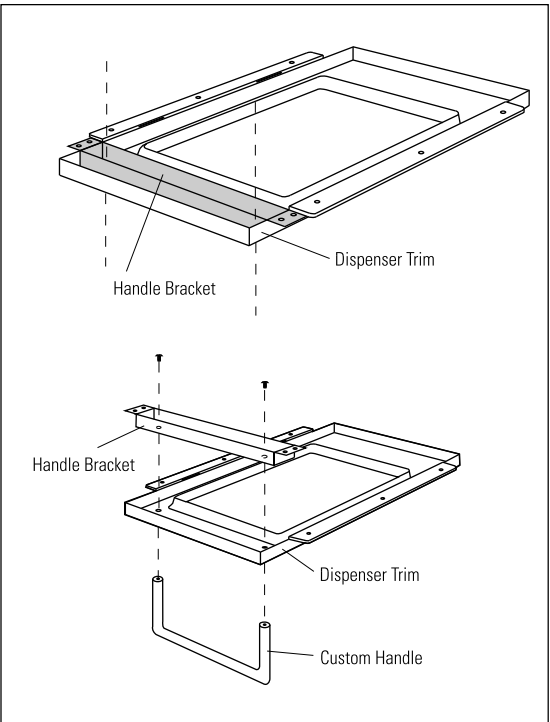

ZKH1 INSTALLATION
INSTRUCTIONS

Step 5 Mount assembled dispenser trim

- Mount assembled dispenser trim with handle onto the door.
- Drive 2 screws through the top and bottom of the handle bracket into the steel door.
- Re-install the door panel trim above and below dispenser using original screws.

Caution: The handle bracket must be secured to the steel door. If it is not secured properly, the dispenser trim will pull away from the door.

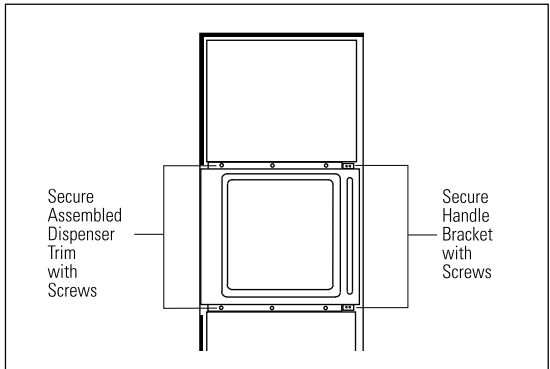

Step 6 Install custom handle extrusion

- Slide decorator panels into the trim, top and bottom.
- Slide freezer door extrusion in between panels and steel door. Secure with screws.
- To install fresh food handle follow the same procedure as shown in Option 1.

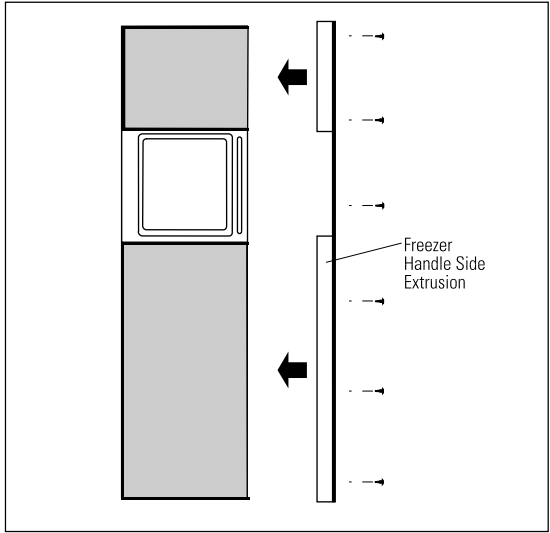

ZG1 Trim Kit

Grille Panel Frame Adjustment

The refrigerator is shipped with the top case trim secured at the 83" refrigerator height. The grille panel frame for the top grille is shipped with the unit and is sized to fit a 84" installation height.

See the *Installation* page 19 to adjust the case trim to the desired height.

This kit provides 3 sets of side trim pieces which allow for 83", 83-1/2" and 84-1/2" installation heights.

- Determine the installation height by measuring the enclosure from floor to underside of soffit or when there is no soffit, to top of adjacent cabinets.
- Select the side trim pieces for your installation height.
- Remove 4 screws (one each on all corners) as illustrated.
- Replace the side pieces with a new set of side trim.
- Re-assemble side and bottom trim pieces.
- Slide panel into the frame and reassemble top trim piece.
- Mount panel grille by dropping into the slots on the case trim.

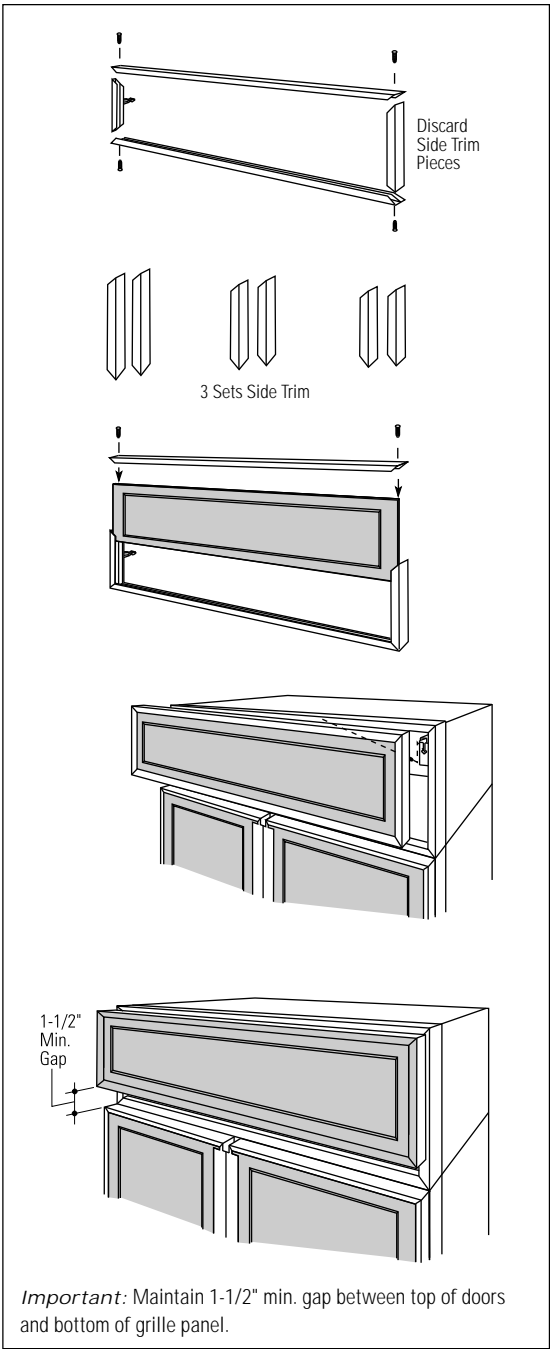

ZKT36 Trim Kit

3/4" Custom Panels

Tools and materials required:

- #2 Phillips screwdriver
- Stubby Phillips screwdriver
- Drill and appropriate bits
- Safety glasses
- Custom panels

These instructions are divided into 2 options:
Option 1—For non-dispenser and dispenser models using custom collar trim.
Option 2—For dispenser model using the standard full-width trim.

Kit contents

Parts List:

Freezer Door
A. Top trim
B. Side trim
C. Bottom trim

Fresh Food Door
D. Top trim
E. Side trim
F. Bottom trim
G. Panel support brackets (4)
H. 4-3/8" screws for support brackets (20)
I. Grille support panel and screws
ZKT36—6 screws
J. Wood screws #6 1/2" flat-head screws
ZKT36—30 screws

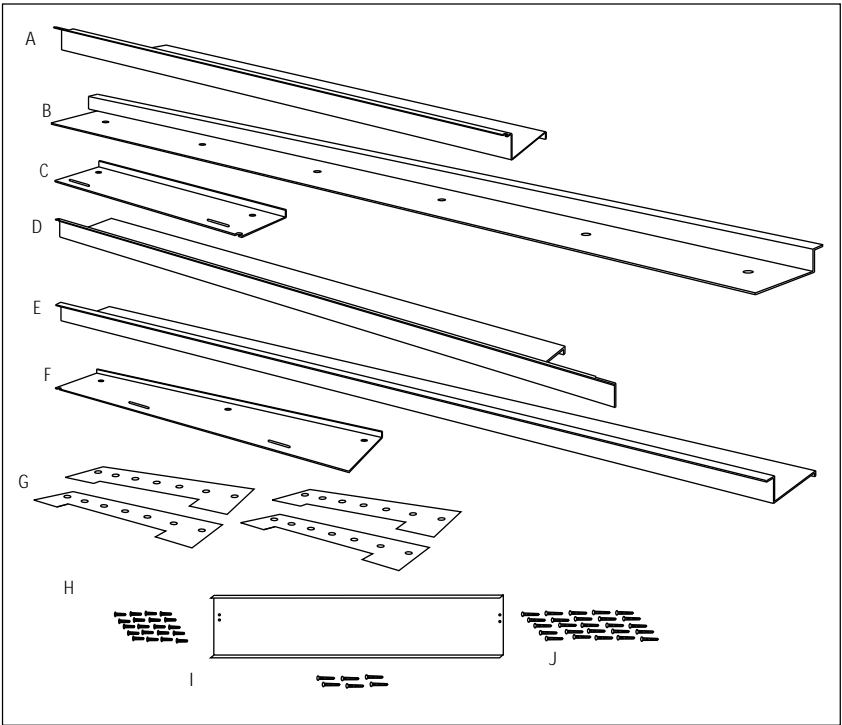

This kit provides for the installation of 3/4" custom door and grille panels, using the standard full length handle. This kit contains all the necessary parts to apply 3/4" panels on dispenser and non-dispenser models. Follow the instructions for Option 1 when applying custom panels to a non-dispenser model or dispenser model using custom collar trim. Follow instructions in Option 2 for a dispenser model using the standard full-width dispenser trim.

Note: If you are using custom handles, see ZKHT1 Installation Instructions.

ZKT36 Trim Kit

3/4" Custom Panels

OPTION 1
For non-dispenser
model
or dispenser model
using custom
collar trim

Step 1
Remove
handles & trim

- Carefully remove the Phillips head screws from the door handle endcaps, top and bottom.
- Open door to 90°.
- Remove the Phillips head screws from the full-length handles.
- Open the doors fully to stop.
- Remove the screws from the aluminum trim, top, bottom and hinge side.
- Retain screws and endcaps. Discard original trim.

Note: If a custom collar is to be used, order ZWCD1 trim kit. If a custom handle is to be used, order ZKHT1 trim kit.

Important: When the bottom trim piece is removed, an aluminum shim secured to the bottom of the door can be seen. Do not attempt to remove this piece.

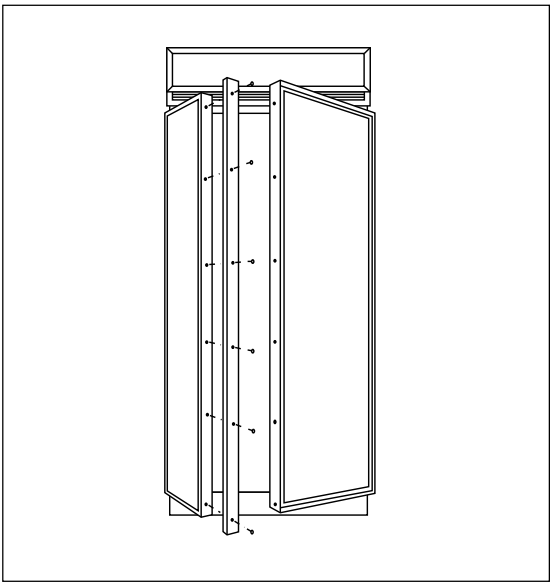

Step 2
Install
3/4" trim

- Attach the new 3/4" trim pieces on the top, hinge side and bottom using original screws.

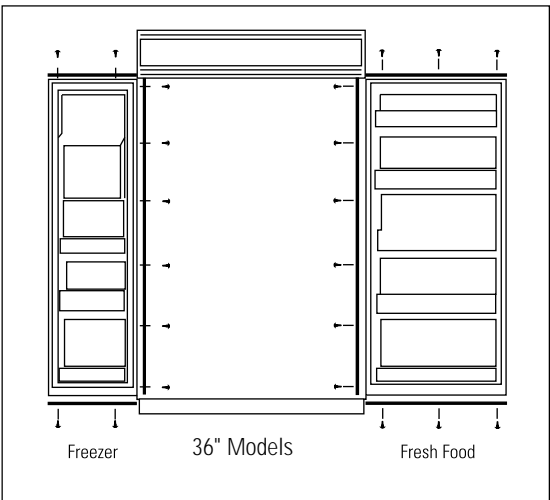

ZKT36 Trim Kit

3/4" Custom Panels

Option 1 Installation

Step 3 Apply panel support brackets

Dimension A
ZKT36-6-3/4"

Dimension B
ZKT36-7-7/8"

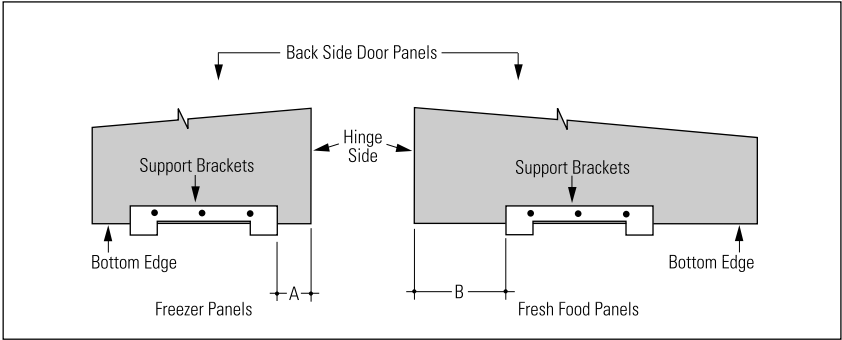

- Position support bracket on freezer panel, dimension A, from the hinge side edge.
- Position support bracket on fresh food panel, dimension B, from the hinge side edge.
- Secure support brackets to the bottom of the panels with #4 screws provided. Align the brackets flush with the bottom of the panels, with tabs protruding below.
- Bracket location measured from the hinge side, is the same for panels with custom handles or standard handles.

Step 4 Install panels

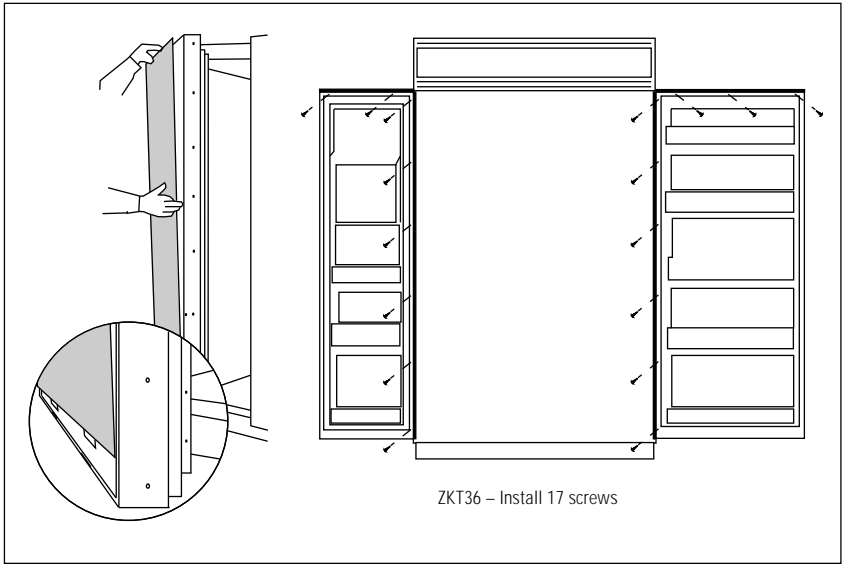

- Place the 3/4" panel on the bottom trim with support bracket tabs inserted into slots. Push the panel back against the steel door, making sure panel is flush to hinge side trim.
- Carefully drill starter holes in panel using a small drill bit.
- Attach the panel to the top and hinge side by installing screws from the back of the trim through the wood panel.
- Follow the same procedure to install fresh food door panel.
- Re-install door handles with original screws.
- Re-install endcaps, top and bottom.

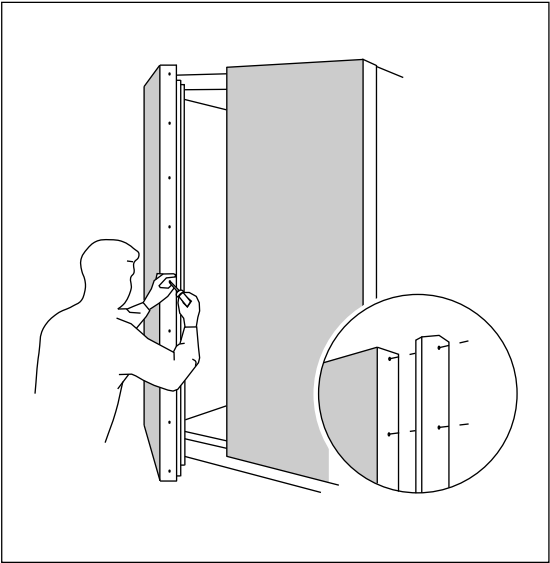

ZKT36 INSTALLATION
INSTRUCTIONS

ZKT36 Trim Kit

3/4" Custom Panels

Option 1 Installation

Step 5 Adjust grille panel height

The refrigerator is shipped with the top case trim secured at the 83" refrigerator height.

- Loosen 2 screws on both sides and raise the case trim to meet soffit height, from 83" to 84-1/2".
- Tighten all 4 screws.

Grille panel mounting slots attached to the case trim are set for a 84" soffit height. The height of the decorative panel can vary with soffit or installation height. See grille panel sizes for your model in "Custom Panel Dimensions".

Important: Maintain 1-1/2" min. gap between top of doors and bottom of grille panel.

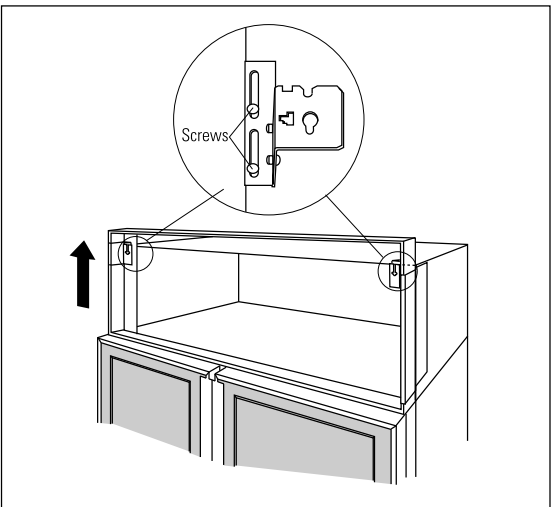

Step 6 Secure 3/4" panel to grille panel support

- Secure the new grille panel support to the back side of the 3/4" panel with #6 screws.

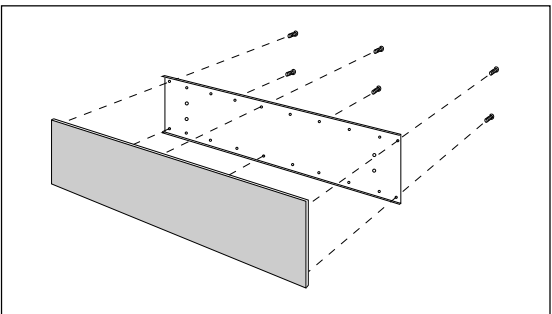

Step 7 Install grille panel

- Install four of the six larger under cut screws such that the top of the screws are 1/16" from the surface of the support.

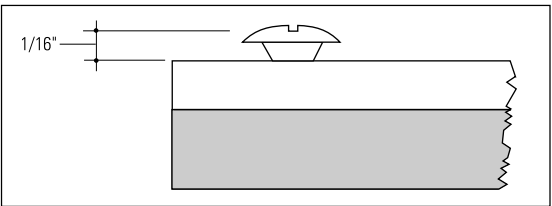
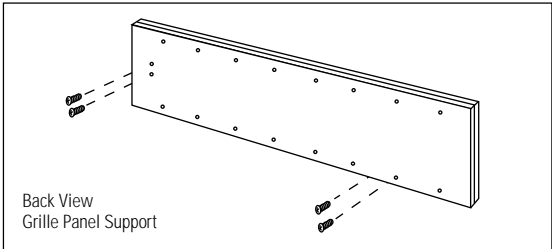

- Attach the assembled panel to the grille frame by inserting the four protruding screws into brackets located on each side of the grille frame.

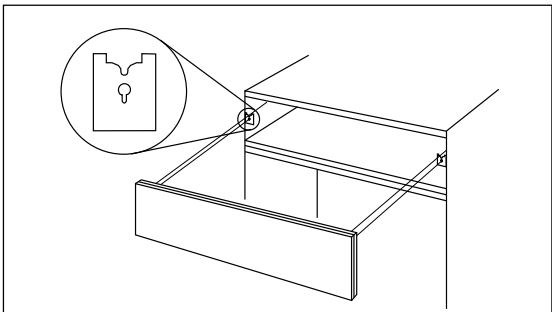

ZKT36 Trim Kit

3/4" Custom Panels

OPTION 2
For dispenser
model using
full-width
trim

Step 1
Remove
handles & trim

- Carefully remove the Phillips head screws from the freezer door handle endcaps, top and bottom.
- Open freezer door to 90°.
- Remove the Phillips head screws from the full-length handles.
- Open door fully to stop.
- Remove screws from the aluminum trim, top, bottom and hinge side.
- Remove the trim above and below the dispenser.
- Retain screws and full-length handles. Discard original trim.

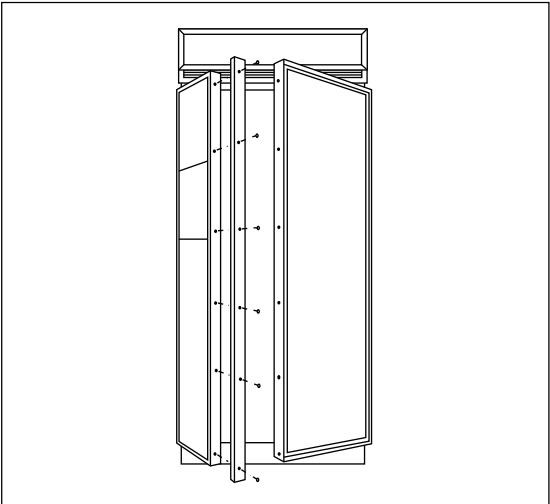

Step 2
Install
3/4" trim

- Attach the new 3/4" trim pieces at the top and hinge side using original screws.

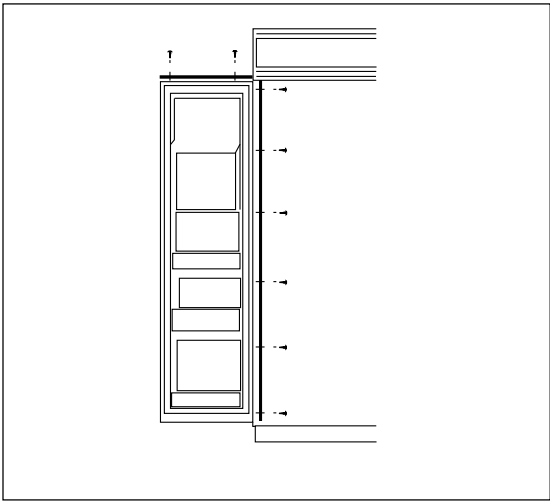

Step 3
Install panel
support brackets

- Position and mark the location for the support brackets on the back side of the panels. Align all brackets flush with the end of the panels, with tabs protruding over the edge.
- On the bottom of the upper panel, measure dimension A from the hinge side.
- On the bottom of the lower panel, measure dimension B from the hinge side.
- On the top of the lower panel, measure dimension C from the hinge side.
- Secure all brackets with #4 screws provided.

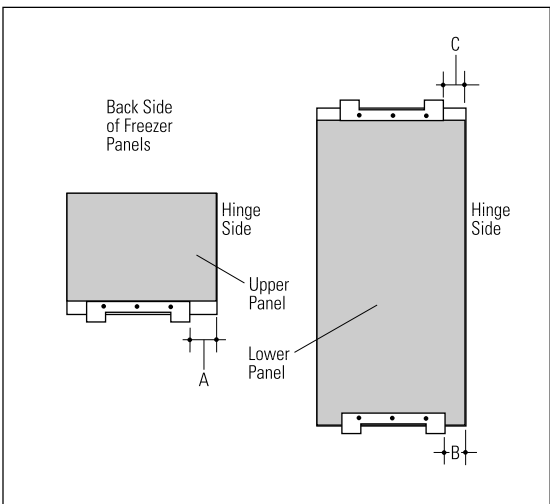

Dimension A
ZKT36-4-3/8"

Dimension B
ZKT36-6-3/4"

Dimension C
ZKT36-4-3/8"

ZKT36 INSTALLATION
INSTRUCTIONS

ZKT36 Trim Kit

3/4" Custom Panels

Step 4
Install
panels

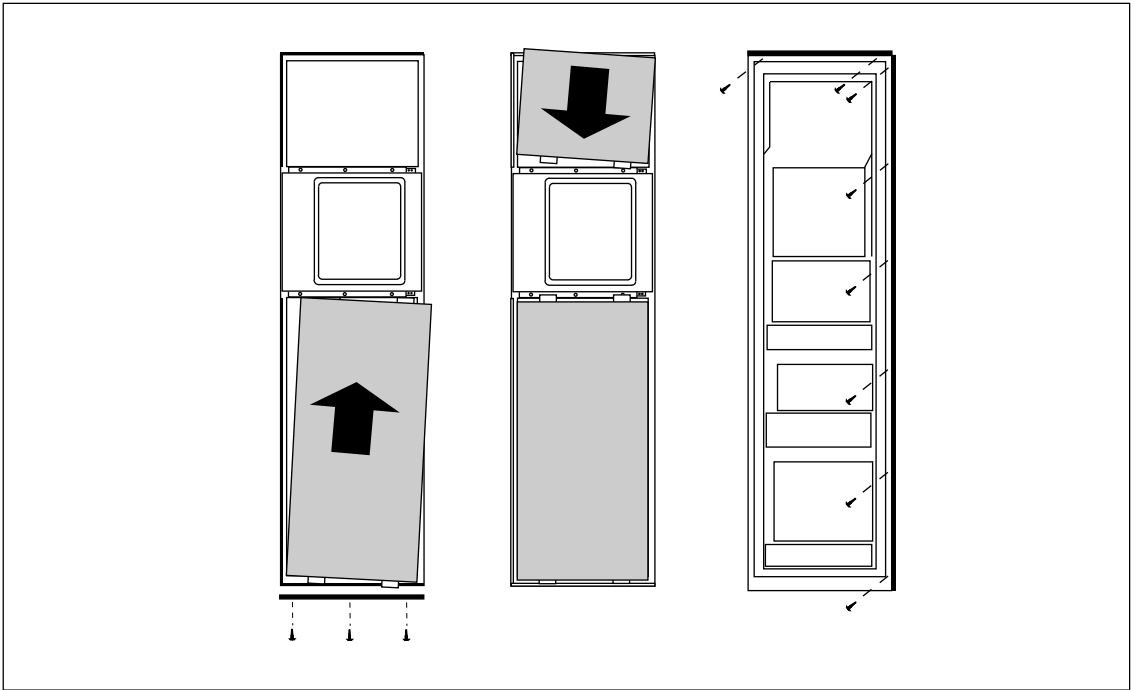

- Install the lower panel by slipping tabs into the slots on the underside of the dispenser trim.
- Hold in position while fitting new bottom trim against the bottom of the door. Tabs should protrude through the bottom trim.
- Install screws up through the bottom trim using stubby Phillips screwdriver.
- Open door and install screws through the back side of the trim and into the panel at the hinge side.
- Place the upper panel onto the top of the dispenser with tabs inserted into the slots.
- Push the panel back against the steel door.
- Open door and install screws through the back of the trim and into the panel, at the top and hinge side.

Step 5
Install
handles

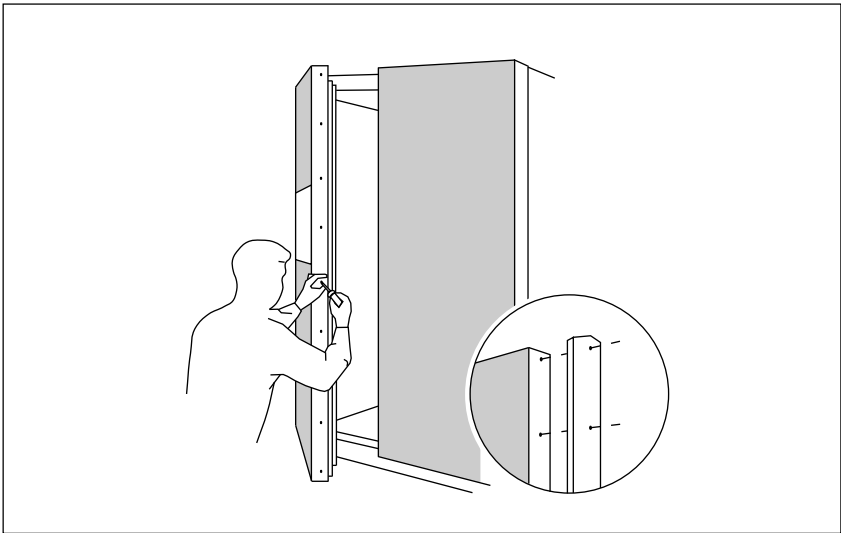

- Install door handle using original screws.
- Re-install endcaps, top and bottom.
- Install panel on fresh food door using the same procedure as in Option 1.
- Install grille panel using the same procedure as in Option 1.

ZKHT1 Trim Kit

Custom Handles with 3/4" Panels

- Tools and materials required:
- #2 Phillips screwdriver
 - Stubby Phillips screwdriver
 - Drill and appropriate bits
 - Custom panels
 - Custom handles
 - Safety glasses

Note: This kit must be used in conjunction with ZKT36 trim kit for 3/4" panel trim.

These instructions are divided into 2 options:
Option 1—For non-dispenser and dispenser models using custom collar trim.
Option 2—For dispenser model using the standard full-width trim.

Kit contents

- Parts List:
- A. Fresh food door extrusion
 - B. Freezer door extrusion for non-dispenser model and dispenser model using custom collar. (Option 1)
 - C. Freezer door extrusion for dispenser model using full-width trim. (Option 2)
 - D. Freezer door handle bracket for dispenser model using full-width trim. (Option 2)

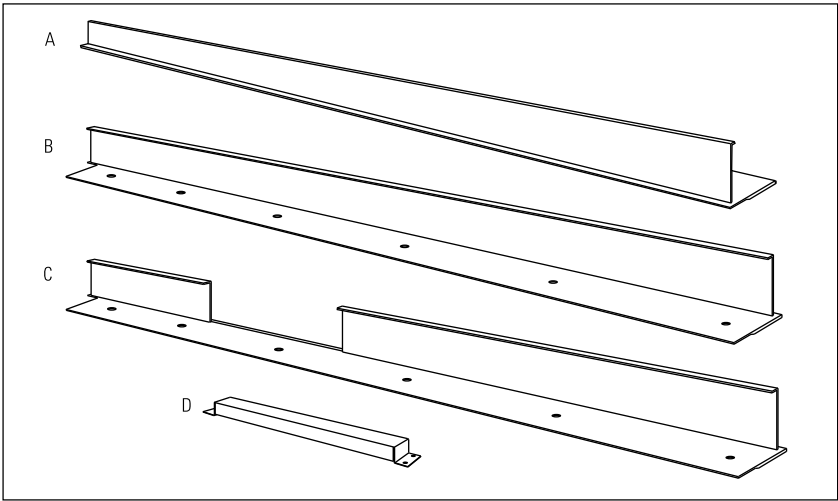

This kit provides for the installation of custom handles on 3/4" thick decorator door panels. The door extrusions and bracket allow custom handles to be secured to the door structure, rather than the door panels. This kit contains all the necessary parts for dispenser and non-dispenser models. Follow the instructions in Option 1 when applying custom handles to a non-dispenser

model or dispenser model using custom collar trim. Follow the instructions in Option 2 for a dispenser model using the standard full-width dispenser trim.

OPTION 1
For non-dispenser model or dispenser model using custom collar trim

Before you begin

Caution: Optimal final appearance depends on careful routing depth. Do not exceed 1/4" routing depth.

3/4" custom door panels must be routed to accommodate these door extrusions. Rout the panels as illustrated, a maximum of 1/4" deep, and 1-13/16" wide, top to bottom on the handle side.

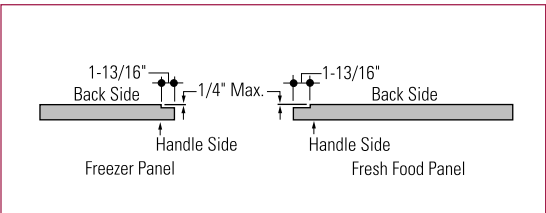

Refer to installation instructions for ZKT36 trim kit for 3/4" custom panels Option 1.

- Follow Step No. 1 to remove the standard aluminum trim.
- Follow Step No. 2 and 3 to attach new 3/4" trim pieces and install panel support brackets.

ZKHT1 INSTALLATION INSTRUCTIONS

ZKHT1 Trim Kit

Custom Handles with 3/4" Panels

Step 1
Temporarily
mount
door panels

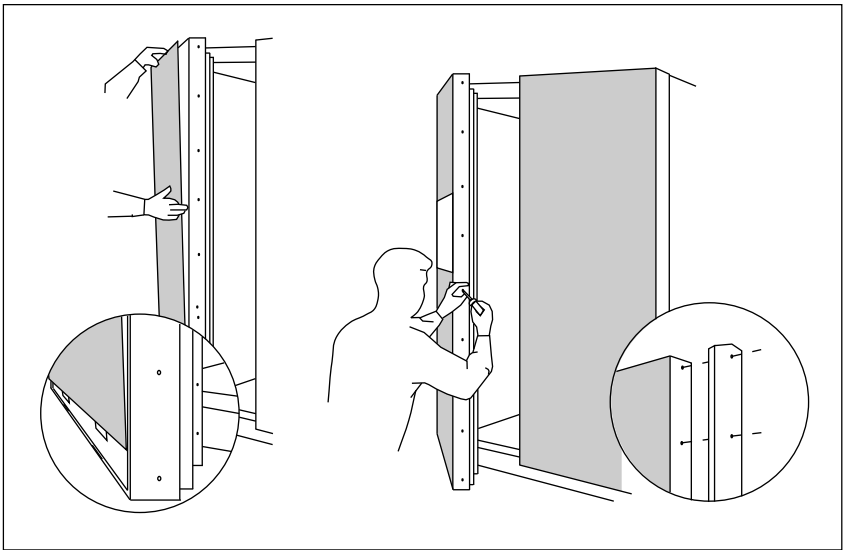

- Place the prepared 3/4" custom door panels on the bottom trim with support bracket tabs inserted into slots.
- Push the panel back against the steel door, making sure panel is flush with hinge side trim.
- Secure the panel to the trim temporarily by driving 2 screws through the back side of the trim at the top.
- Slide door extrusion in between panel and steel door. Temporarily secure with 2 screws.

Step 2
Locate
position
of handles

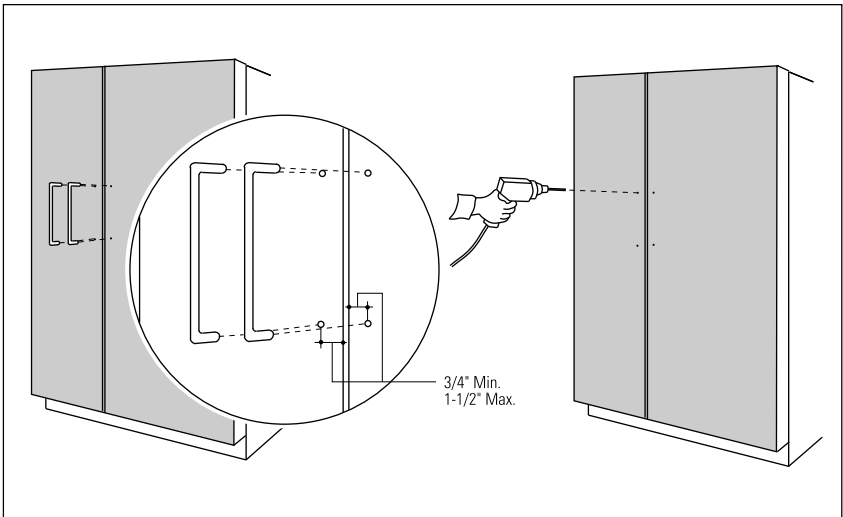

- Determine the desired location of the custom handles and carefully mark centerlines of the screw holes. The handles must be located 3/4" to 1-1/2" from the end of the extrusion.
- Again, with both doors closed, check centerlines of the screw holes to be sure they are parallel to the edge of the door, and level with opposite door.
- Drill 1/16" pilot hole through the panel until it starts into the aluminum extrusion. This will mark the matching location for drilling a clearance hole when assembling the extrusion, panel and handle.

ZKHT1 Trim Kit

Custom Handles with 3/4" Panels

Option 1 Installation

Step 3
Assemble panel,
extrusion
and handle

- Remove the door extrusions and door panels.
- Drill 1/16" pilot hole through extrusion.
- Drill clearance holes through the panel and extrusion.
- Assemble the door panel, extrusions and custom handle.
- Install screw(s) long enough to pass through the extrusion, door panel and into the handle.

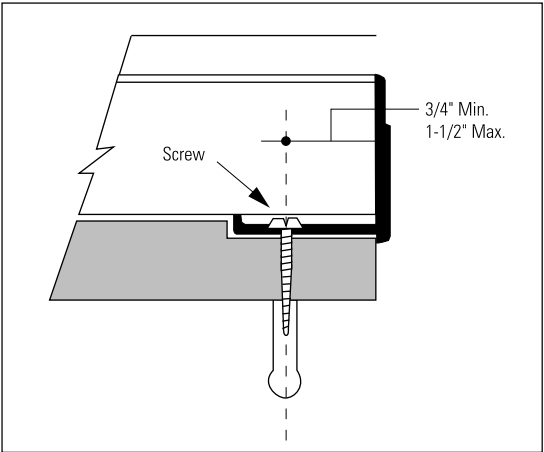

Step 4
Mount
assembled
panels

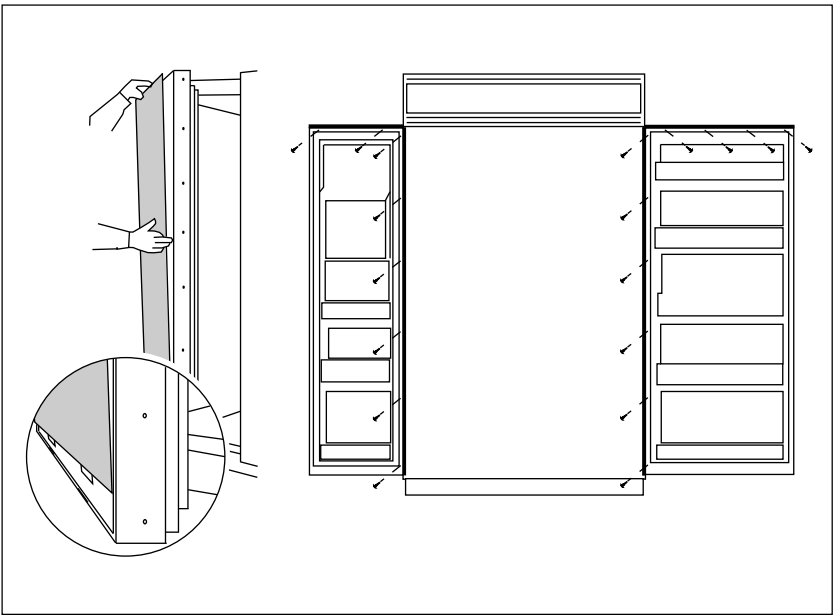

- Place assembled panel onto bottom trim with support bracket tabs inserted into slots.
- Push the panel back against the steel door with door extrusion flush to the handle side of the door.
- Open door fully to stop.
- Install screws at the top, hinge side and end of door extrusion.

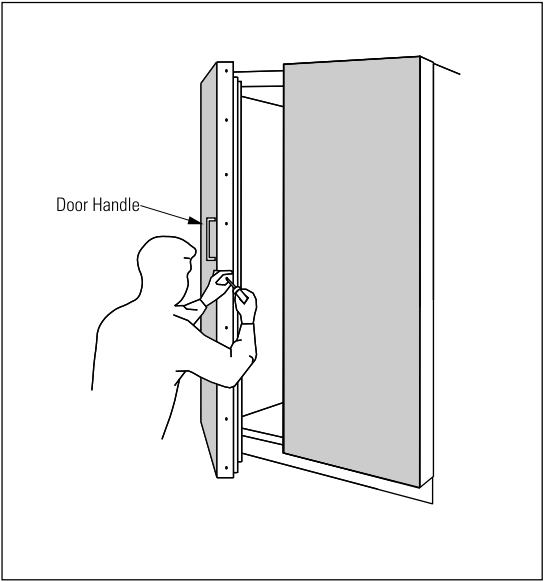

ZKHT1 INSTALLATION
INSTRUCTIONS

ZKHT1 Trim Kit

Custom Handles with 3/4" Panels

Option 1 Installation

OPTION 2
For dispenser
model using
full-width
trim

Before
you
begin

Caution: Optimal final appearance depends on careful routing depth. Do not exceed 1/4" routing depth.

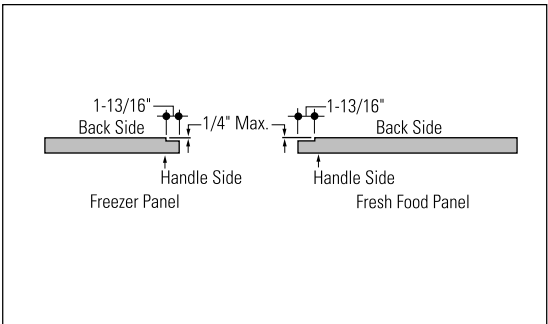

All 3 custom door panels must be routed to accommodate the door extrusions. Route the panels as illustrated, max. 1/4" deep, 1-13/16" wide, top to bottom on the handle side.

Refer to installation instructions for ZKT36 trim kit, Option 2.

- Follow Step No. 1 to remove standard aluminum trim.
- Follow Step No. 2 and 3 to attach new 3/4" trim pieces and install panel support brackets.

Step 1 Locate position of handle

Note: The custom handle must be installed against the handle bracket. The custom handle cannot exceed 11-3/4" length.

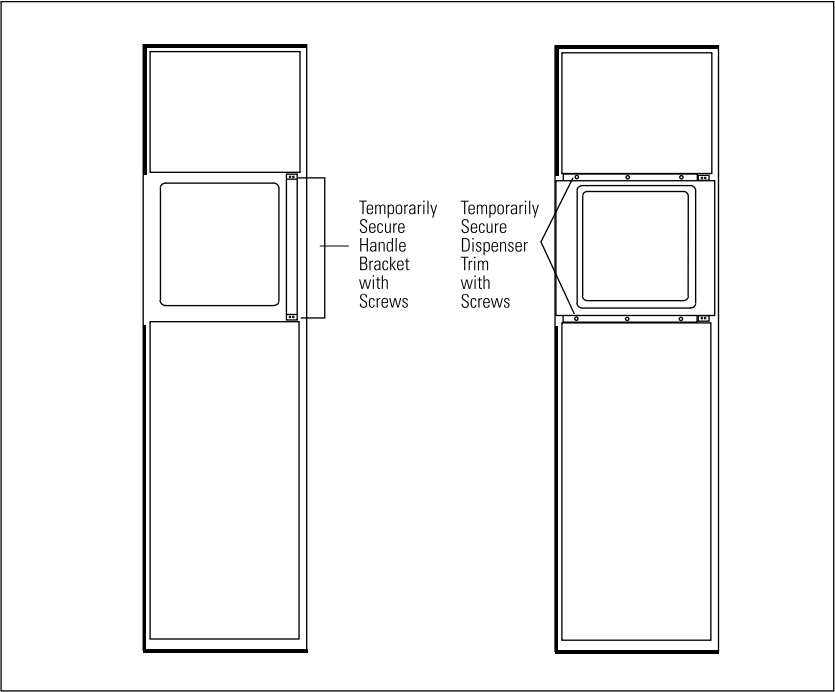

- Position the handle bracket onto the steel door by matching existing screw holes on the door and bracket.
- Re-install dispenser trim, temporarily.
- Determine the desired location of the custom handle and carefully mark centerlines of the screw holes.

- Drill 1/16" pilot hole through the trim until it starts into the handle bracket. This marks the same location onto the bracket.
- Remove dispenser trim and bracket.

ZKHT1 Trim Kit

Custom Handles with 3/4" Panels

Option 2 Installation

Step 2
Install
custom handle

- Drill clearance holes through the handle bracket and the dispenser trim.
- Install screw(s) long enough to pass through the handle bracket, dispenser trim and into the custom handle.

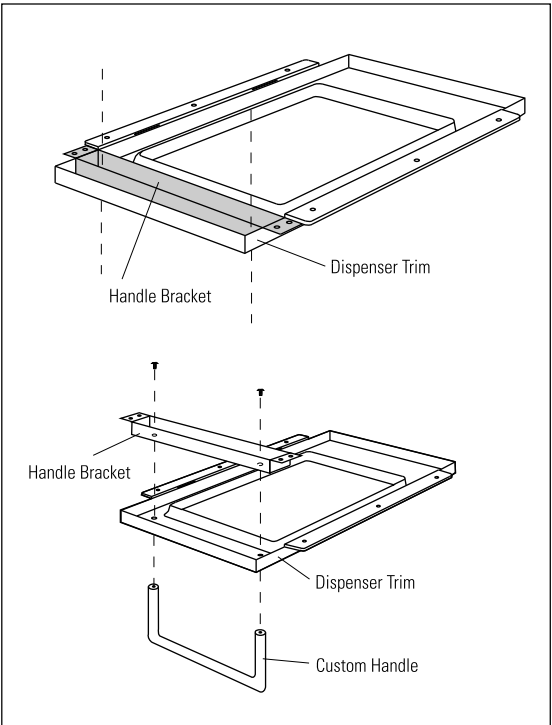

Step 3
Mount
assembled
dispenser
trim

- Mount assembled dispenser trim with handle onto the door.
- Drive 2 screws through the top and bottom of the handle bracket into the steel door.
- Re-install 3 screws at top and bottom of dispenser trim.

Caution: The handle bracket must be secured to the steel door. If it is not secured properly, the dispenser trim will pull away from the door.

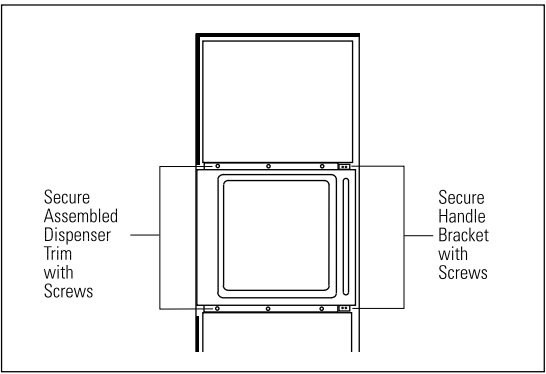

Step 4
Finalize
installation

- Again, refer to ZKT36 trim kit, Option 2.
- Follow Step 4 to install freezer door panels and bottom trim.
 - Slide freezer handle side extrusion in between panels and steel door. Secure with screws.
 - To install fresh food handle, follow the same procedure as in Option 1.

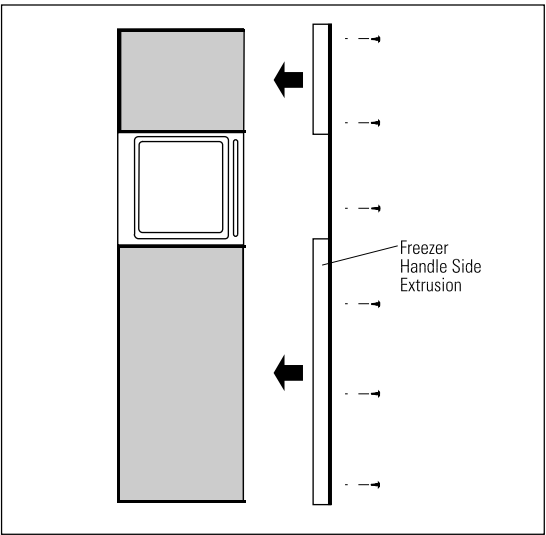

ZKHT1 INSTALLATION
INSTRUCTIONS

Select panel size

Kit contents

- Tools and materials required:**
- #2 Phillips screwdriver
 - Drill and appropriate bits
 - Custom door panels
 - Safety glasses

- Parts List:**
- A. Collar trim
(Both black and white trim included)
 - B. Top bracket
 - C. Bottom bracket
 - D. Screws (2)

This kit provides for the use of a custom dispenser collar trim, replacing the standard full-width trim. This kit can be used alone, or combined with one or all other trim kits.

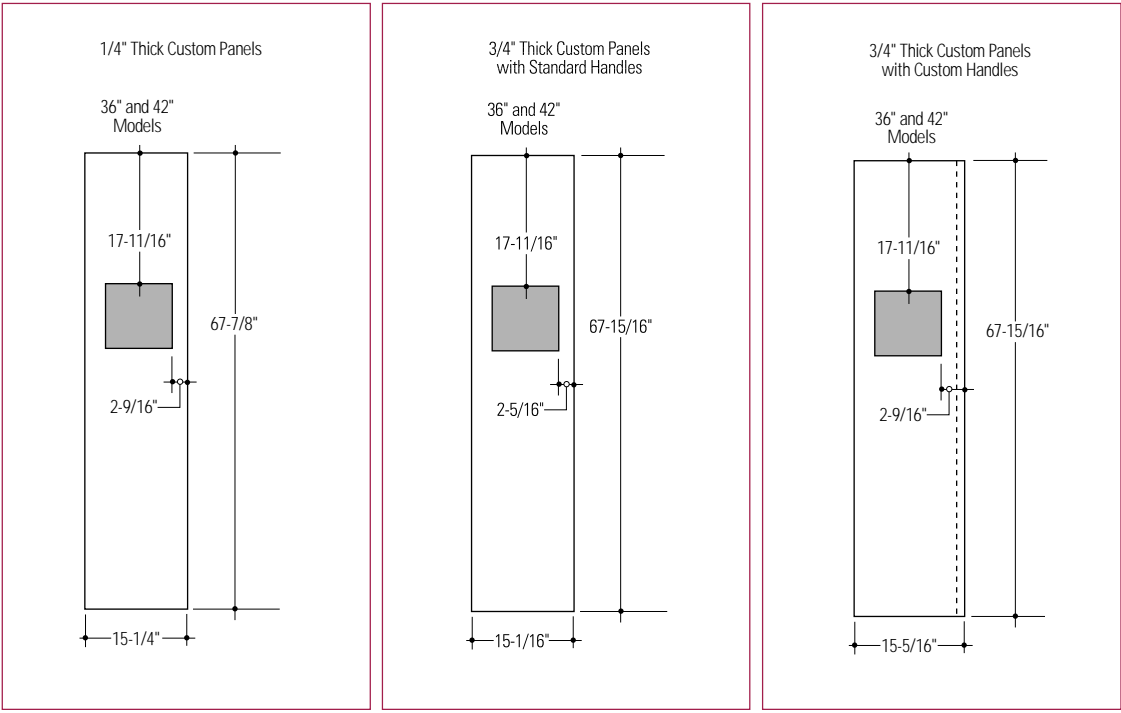
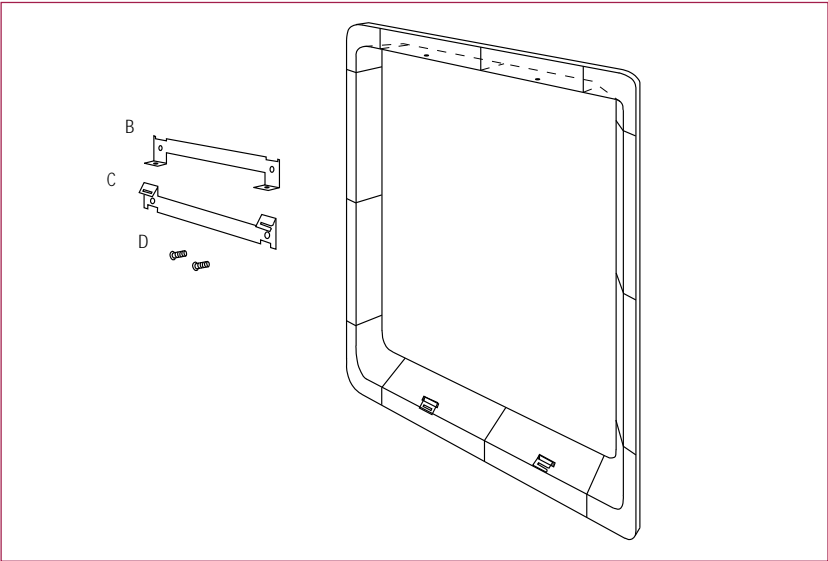

- The overall size of the panel is determined by the application being used.
- 1/4" thick panels using the standard handles or optional custom handles.
 - 3/4" thick panels using standard handles, or
 - 3/4" thick panels using optional custom handles. Select the panel size accordingly.

ZWCD1 Trim Kit

Custom Dispenser Collar

ZWCD1 Trim Kit

Custom Dispenser Collar

Cut dispenser hole and rout door panel

The use of this custom collar trim requires that the hole for dispenser be located and cut *very accurately*. 3/4" door panels must be routed on all 4 sides of the dispenser cutout.

Rout the back side of the panel 1/4" deep and 7/8" wide, flush with the edge of the cutout.

Note: 1/4" door panels do not require routing.

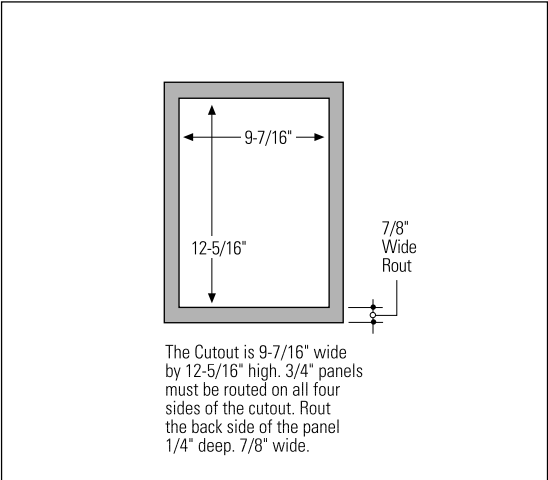

Install collar brackets and trim

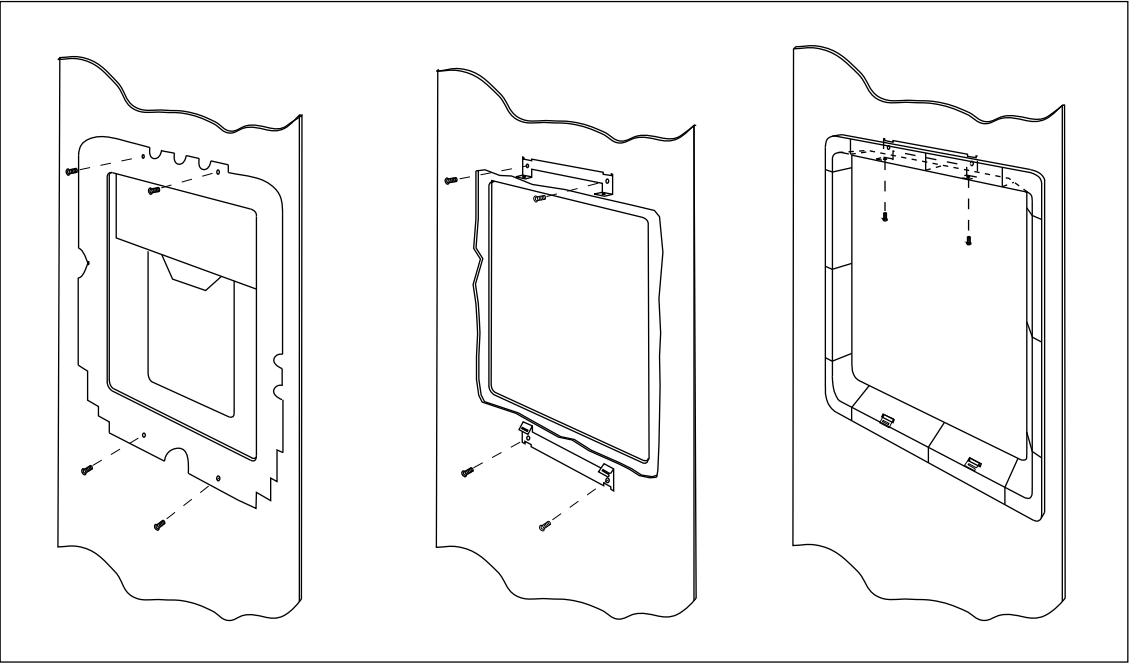

Select the door panel size for your application.

- If using the standard 1/4" trim, follow the installation instructions packed with the product.
- When using another optional trim kit, use the instructions provided with that kit to install the panel trim and/or custom handles.
- Remove the aluminum trim above and below the dispenser. Discard trim.
- Remove and discard the standard full-width dispenser trim.
- Remove 2 screws above and below the dispenser recess. Retain screws.

- Secure top and bottom brackets to the dispenser, using the screws previously removed.
- Install the custom panels according to the appropriate installation instructions.
- Select the black or white collar trim according to appearance desired.
- Match the indentations on the collar trim to the tabs on the lower bracket. Push the collar flush against the door.
- Drive 2 screws (provided) upwards through the collar and into the brackets.

ZWCD1 INSTALLATION INSTRUCTIONS

Note: While performing installations described in this book, safety glasses or goggles should be worn.

To obtain specific information concerning any Monogram product or service, call GE Answer Center® consumer information service at 800.626.2000—any time, day or night.

For Monogram™ local service in your area, call 1-800-444-1845.

Note: Product improvement is a continuing endeavor at General Electric. Therefore, materials, appearance and specifications are subject to change without notice.



Pub. No. 49-6898
© 1996 GE Appliances
Printed in U.S.A. (NAI 597)